

**SL-PP62K60**

adhesive push button 62 mm



Thank you for choosing a SIRO light switch!  
These simple instructions will help you to install and use your new switch.

**PRODUCT FEATURES**

- ▶ push button for sticking in the room or furniture.
- ▶ No battery and no wiring necessary!
- ▶ Battery-free device without external power supply.
- ▶ Transmission energy is generated from mechanical energy when the rocker is actuated.
- ▶ Radio-based range up to 80 meters in open areas and 30 meters indoor.
- ▶ Push button can be connected to any number of Push Power Receivers.
- ▶ **Functions:**  
ON - OFF - DIMMING with MONO receiver, no color adjustment possible with DUO, DUO2-Pol and RGB receiver!
- ▶ When several switches are used, a changeover switch function is provided.
- ▶ Available in white (K60) and black (K1) version.

**ASSEMBLY**

- ▶ Installation by simply gluing in any position
- ▶ The substrate must be clean, grease-free and stable

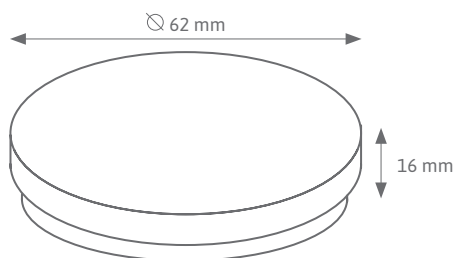
**TECHNICAL DRAWING****DIMENSIONS**

- ▶ Push Taster (DxH): 62 x 16 mm

**TECHNICAL FEATURES**

- ▶ Transmission protocol: RF 433 mhz
- ▶ Range: 30 meters (indoors)
- ▶ IP rating: IP44 (IP20 when the adhesive backing is removed)

**SAFETY AND INSTALLATION INSTRUCTIONS**

- ▶ This product is not a toy and is not suitable for children!
- ▶ The SIRO LED system is only suitable for indoor use.
- ▶ Unprotected outdoor use is not permitted.
- ▶ Contact with moisture must be avoided at all costs!

**SCOPE OF DELIVERY**

- ▶ Push button
- ▶ adhesive strips in circular shape

## SL-PP62K60 (white)

adhesive push button 62 mm

### Only combinable with the following SIRO PushPower products:

Receiver:	SL-PPREC02TRIAC (230V dimmable), SL-PPREC02SWITCH (230V), SL-PPREC01MONO(12-48V dimmable), SL-PPREC01DUO (12-48V dimmable), SL-PPREC01DUO2W (12-24V dimmable), SL-PPREC01RGB (12-48V dimmable)
Top hat rail:	SL-PPREC03RAIL2 (230V)
Switch Socket:	SL-PPREC01AC-K60 (230V)

### GENERAL FUNCTIONS

1	1-way button
Single click:	Switching on or off
Click and hold button:	Dimming 5 - 100%
Double click:	Switch off all
Click and hold when switched off:	Night mode (5% brightness)

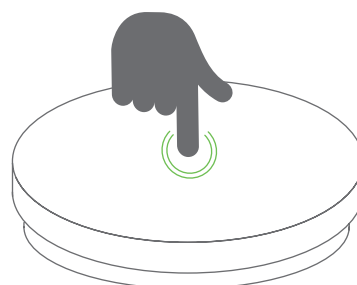

### POSSIBLE COMBINATIONS

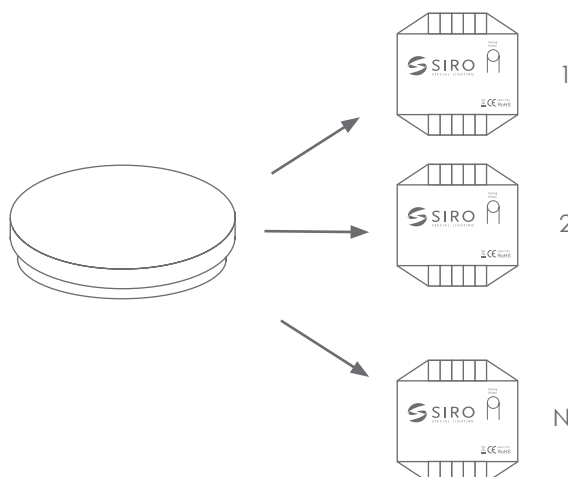
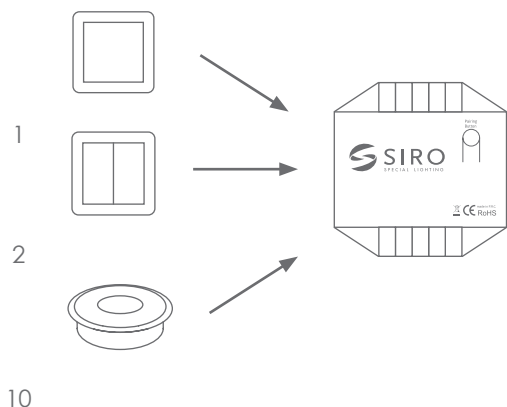

#### More controls on one receiver

a maximum of 10 PushPower control units (sensors, push buttons, etc.) can be connected to one receiver. Every option counts.

#### One control on several receivers

1 PushPower control unit can control any number of receivers.

#### Radio range (depending on the local conditions)

up to 30 m indoors and up to 80 m outdoors.



## FUNCTIONS IN DETAIL

### CONNECT (TEACH-IN) CONTROL UNIT (SWITCH) & RECEIVER

This is how you establish communication between the switch and your receiver:

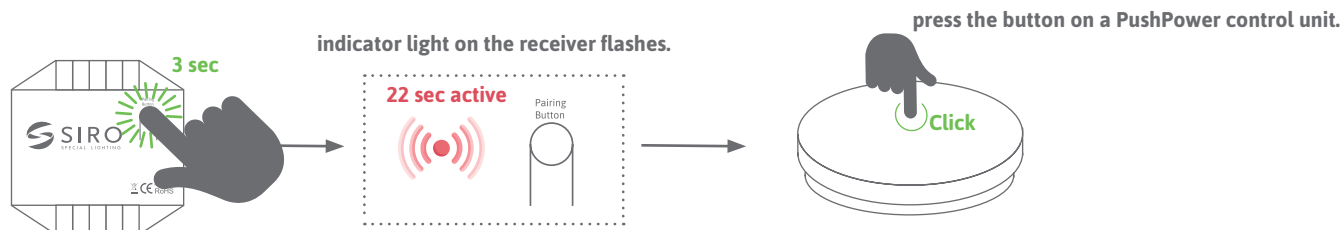

#### press and hold for 3 seconds

The activity mode remains active for 22 seconds, after which the teach-in process is canceled and the light switches off.

The learning process can be canceled by disconnecting the power.

### SINGLE CLICK - ON/OFF

A single click refers to a single, brief press of the light switch.

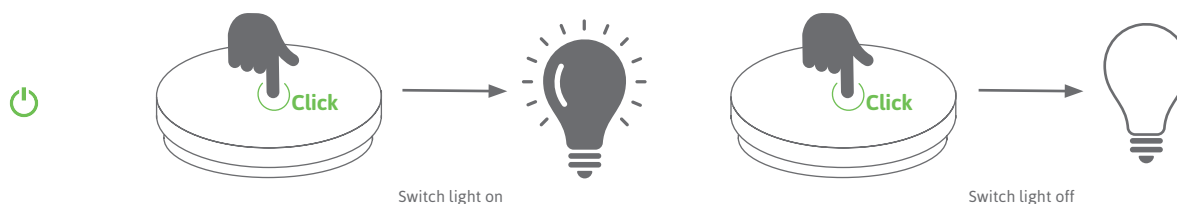

With SIRO light switches, a single click is used to switch the connected light source on or off.

This corresponds to the basic function of a switch, where a single click changes the status of the lighting.

### DOUBLE CLICK - SYNCHRONIZE

A double click refers to pressing the light switch twice in quick succession.

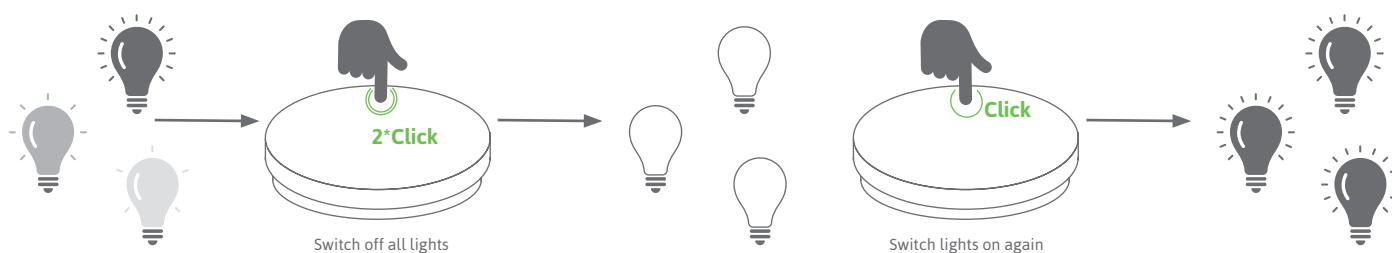

All lights are switched off. This function is used to synchronize several lights when they are running asynchronously.

### RESETTING THE RECEIVER / FACTORY STATUS

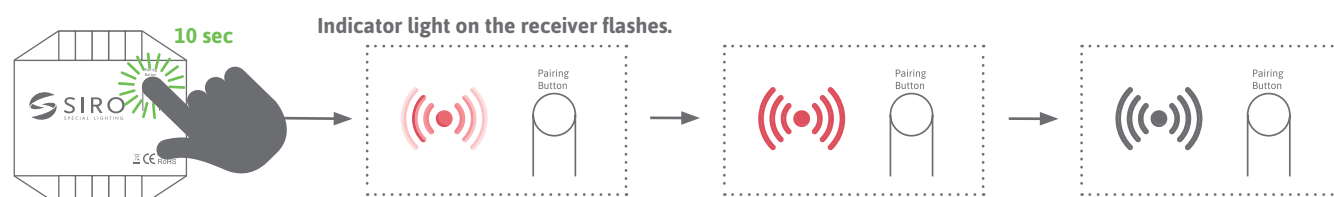

Press and hold for 10 seconds. All connections are now deleted and the receiver is ready for a new link.

## SLOW CLICK / Hold - DIMMING

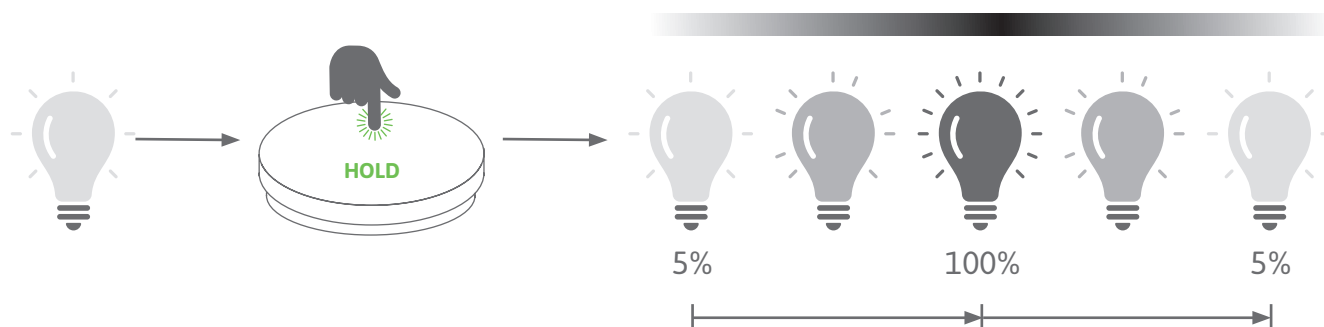

A longer press on the switch can be used to continuously increase or decrease the brightness.

This enables precise adjustment of the lighting according to individual preferences. By default, the light starts at 50% brightness.

Pressing and holding the dimming function starts the light with cyclical dimming.

## MEMORY FUNCTION

The system always remembers the last setting of the lighting situation before switching off. (power failure)

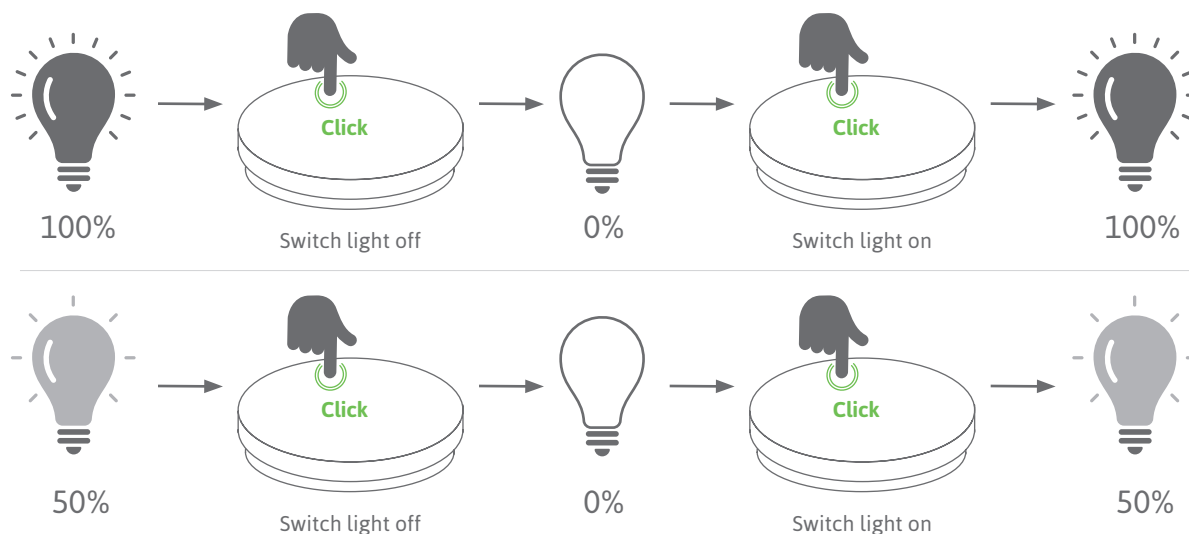

## SLOW CLICK WHEN LIGHT IS SWITCHED OFF / NIGHT MODE

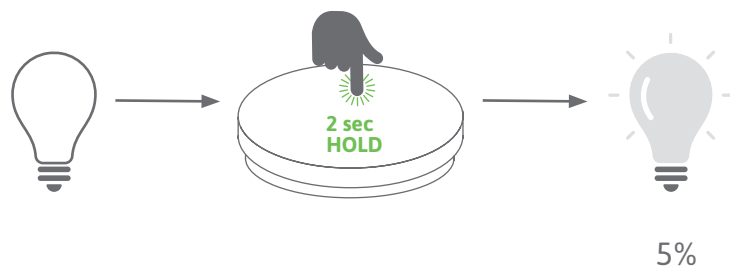

A longer press (2 seconds) on the switch when it is switched off can be used to activate the night light.

The light starts at 5% brightness.