

SL-PP62K1

COOKIE - Push button 62 mm (black)



Thank you for choosing a SIRO light switch!
These simple instructions will help you to install and use your new switch.



PRODUCT FEATURES

- ▶ Push button to stick in the room or on furniture.
- ▶ No battery and no wiring necessary!
- ▶ Battery-free device without external power supply.
- ▶ Transmission energy is generated from mechanical energy when the push button is pressed.
- ▶ Radio-based range up to 80 meters.
- ▶ Push Button can be connected to any number of Push Power Receivers.
- ▶ Functions: ON - OFF - DIMMING with MONO receiver ON - OFF - DIMMING with DUO receiver (no color change possible!)
- ▶ A changeover switch function is provided when several switches are used.
- ▶ Available in black (K1) version

ASSEMBLY

- ▶ Free to use,
- ▶ glue with adhesive dots

TECHNICAL DRAWING

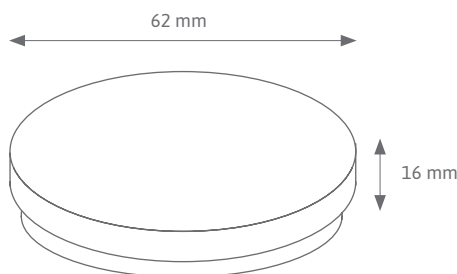

DIMENSIONS

- ▶ Push button (DxH): 62 x 16 mm

TECHNICAL FEATURES

- ▶ Transfer protocol: RF 433 mhz
- ▶ Range (without mesh): 30 meters (indoors)
- ▶ IP Rating: IP20

SAFETY AND INSTALLATION INSTRUCTIONS

- ▶ This product is not a toy and is not suitable for children!
- ▶ The SIRO LED system is only suitable for indoor use. Unprotected outdoor use is not permitted. Contact with moisture must be avoided at all costs!

SCOPE OF DELIVERY

- ▶ Pushbutton
- ▶ Adhesive strips in a circle shape

SL-PP62K1

COOKIE - Push button 62mm (black)

Ideally combinable with the following SIRO PushPower products:

Receiver:	SL-PPREC02TRIAC (230V dimmable), SL-PPREC02SWITCH (230V), SL-PPREC01MONO(12-48V dimmable), SL-PPREC01DUO (12-48V dimmable)
Top hat rail:	SL-PPREC03RAIL2 (230V)
Switch socket:	SL-PPREC01AC-K60 (230V)

GENERAL FUNCTIONS 1, 2

1-way button	
Single click:	Switching on or off
Click and hold when switched on:	Dimming 2 - 100%
Double-click:	Switch off all
Click and hold when switched off:	Night mode (2% brightness)

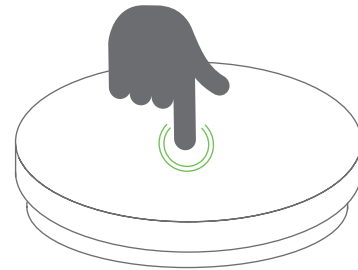

POSSIBLE COMBINATIONS

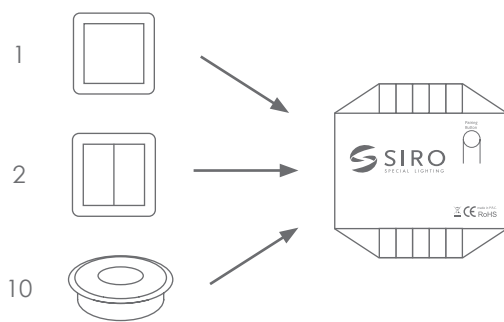

Multiple controls on one receiver

maximum of 10 PushPower controls (sensors, push buttons, etc.) can be connected to a receiver. Every option counts.

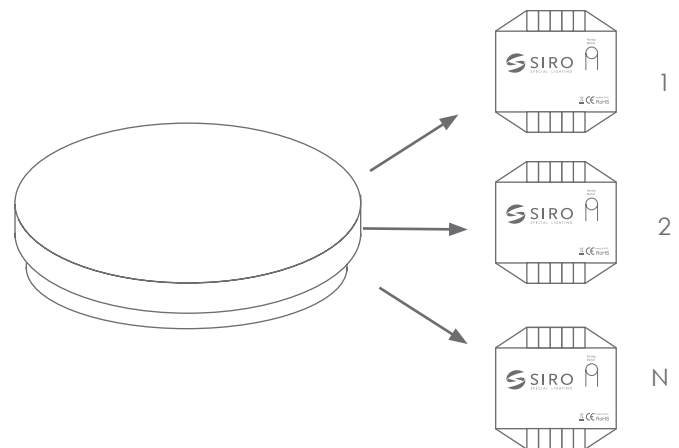

One control on several receivers

1 PushPower control device can control any number of receivers.

Radio range (depending on the local conditions)

up to 30 m indoors and up to 80 m outdoors



FUNCTIONS IN DETAIL

CONNECT (TEACH-IN) CONTROL UNIT (SWITCH) & RECEIVER

This is how you establish communication between the switch and your receiver:

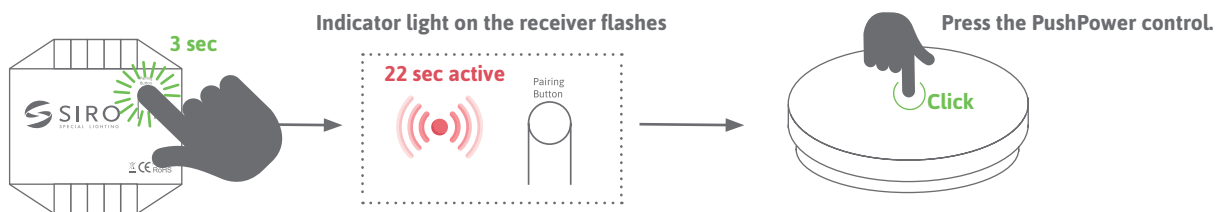

2-way switch (2 options)

press and hold for 3 seconds

Activity mode remains active for 22 seconds, after which the teach-in process is canceled and the light switches off.
The learning process can be canceled by disconnecting the power.

SINGLE CLICK - ON/OFF

A single click refers to a single, brief press of the light switch.



With SIRO light switches, a single click is used to switch the connected light source on or off.
This corresponds to the basic function of a switch, where a single click changes the status of the lighting.

DOUBLE CLICK - SYNCHRONIZE

A double click refers to pressing the light switch twice in quick succession.

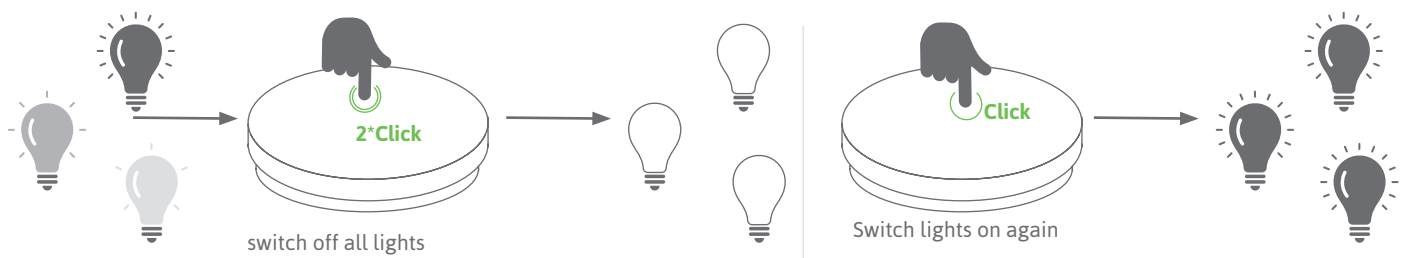

All lights are switched off. This function is used to synchronize several lights when they are running asynchronously.

RESETTING THE RECEIVER / FACTORY STATUS

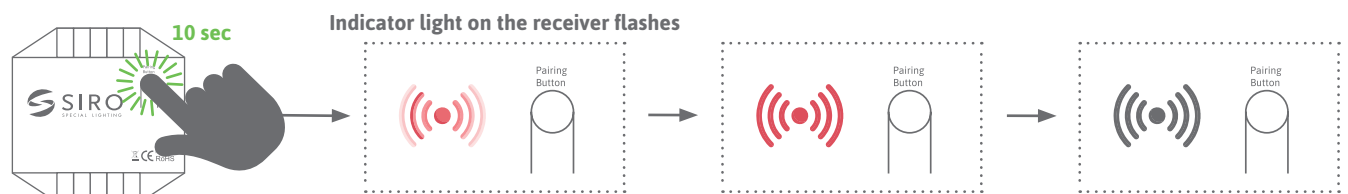

Press and hold for 10 seconds. All connections are now deleted and the receiver is ready for a new link.

SLOW CLICK / Hold - DIMMING

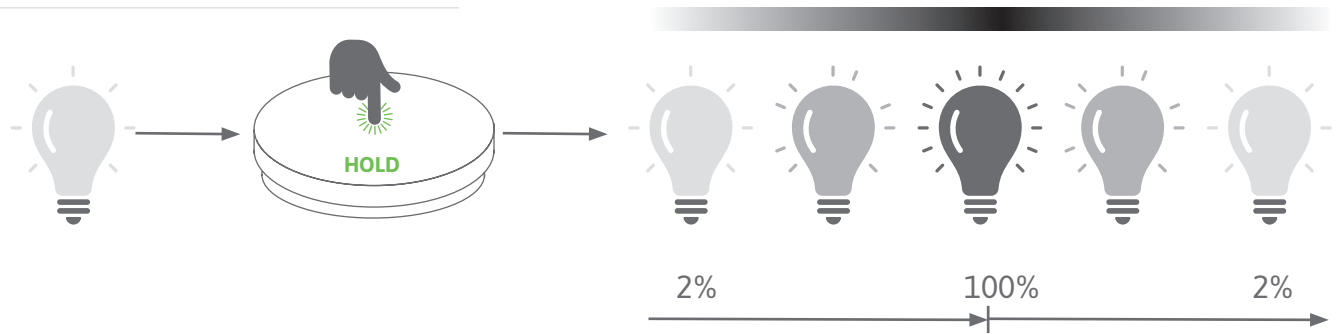

A longer press on the switch can be used to continuously increase or decrease the brightness or color temperature. This enables precise adjustment of the lighting according to individual preferences. By default, the light starts at 50% brightness or 0% cool white and 100% warm white for DUO systems. When the dimming function is activated (press and hold), the light starts dimming cyclically.

SLOW CLICK WHEN LIGHT IS SWITCHED OFF / NIGHT MODE

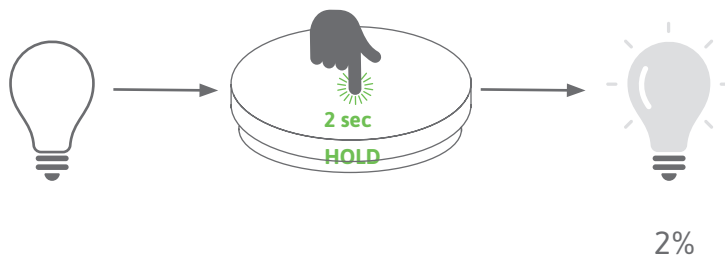

A longer press (2 seconds) on the switch when it is switched off can be used to activate the night light. The light starts at 2% brightness.

MEMORY FUNCTION

The system always remembers the last setting of the lighting situation before switching off. (power failure)

