

LIGHT IN ITS COLORFULNESS

RGB lighting design by SIRO

THE POWER OF RGB

COLOUR IN MOTION – LIGHT BROUGHT TO LIFE.

Whether you prefer manual colour selection in Static mode or an automatic colour flow in dynamic RGB-PLAY mode – the choice is yours. You decide if individual colour accents take centre stage or if gentle transitions set the room in motion. You can also adjust the speed to your liking, ranging from lively and impulsive to calm and meditative, fine-tuning the atmosphere as needed.

Colour Ideas for Your Lighting Mood:

Red: Ideal for lounge areas, bars, or wellness spaces – creates warmth and an inviting atmosphere.

Green: Perfect for quiet rooms, bedrooms, or unwinding after a long day – calming and natural.

Blue: Great for work areas, gaming zones, or modern kitchen lighting – clear, focused, and cool.

Purple/Violet: Ideal for creative studios, boutiques, or events – inspiring and adds a premium feel.

Orange: Suited for living rooms, dining areas, or reception areas – friendly, cosy, and uplifting.

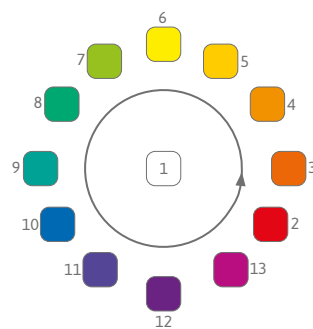

Effortless Wireless Control

Thanks to wireless control via PushPower switches and a precise memory function, the system integrates seamlessly into your routine. With one click, you can recall your favourite scene – reliable, efficient, and with no app required.

Sleek Design & Creative Versatility.

A slim build, flexible handling, and brilliant colour rendering make the SIRO RGB system a perfect solution for creative interior lighting – from display cabinets to large living areas, and from mood lighting to architectural installations. Light should do more than simply shine – it should also captivate.

Tailored LED Solutions for Every Project.

Every lighting project is unique, which is why SIRO offers a suitable LED system for every requirement – from straightforward functionality to creative colour variety. Whether it's accent lighting, functional illumination, or dynamic colour effects, SIRO has the ideal system to match: MONO, DUO, DUO 2-Pol, or RGB.



MONO – The Classic for Pure Light

Opt for timeless elegance: the MONO system delivers reliable, uniform illumination in a fixed light colour – ideal for those who appreciate understated perfection.



DUO – Two Colours, Endless Possibilities

From warm white to cool white – the DUO system allows you to switch between two colour temperatures, adapting effortlessly to your mood and interior concept.



DUO2Pol – Smart Control, Minimal Effort

Maximum functionality with minimal installation: the DUO 2-wire system combines the flexibility of DUO with simplified wiring. Perfect for renovations and retrofitting projects.



RGB – Colour That Inspires

For those who want to design with light: the RGB system delivers true highlights with a vast spectrum of colours. From vibrant and bold to calm and soothing – there are no limits to your creativity.



THE MOST VIVID EXPRESSION OF LIGHT.

The SIRO RGB system opens up a world of new possibilities in lighting design – rich in colour, intuitive to control, and full of atmosphere. Whether you're aiming for defined highlights or dynamic movement throughout your space, this system brings colour to life – as versatile as your mood.

Two Modes – A World of Possibilities:

1) Static Mode – 13 Colours. 13 Moods.

In static mode, choose from 13 predefined shades – each with its own unique atmosphere to transform your space and stir emotion:

Pure White – neutral, clean, functional. Red – passionate, powerful. Red-Orange – lively, energising. Orange – warm, welcoming. Yellow-Orange – cheerful, vibrant. Yellow – sunny, optimistic. Yellow-Green – fresh, creative. Green – balancing, natural. Blue-Green – calm, relaxing. Blue – cool, focused. Blue-Violet – refined, inspiring. Violet – mysterious, luxurious. Red-Violet – sensual, atmospheric. Simply click through to explore – or press and hold for smooth fine-tuning. Create your perfect colour tone, tailored precisely to the moment.

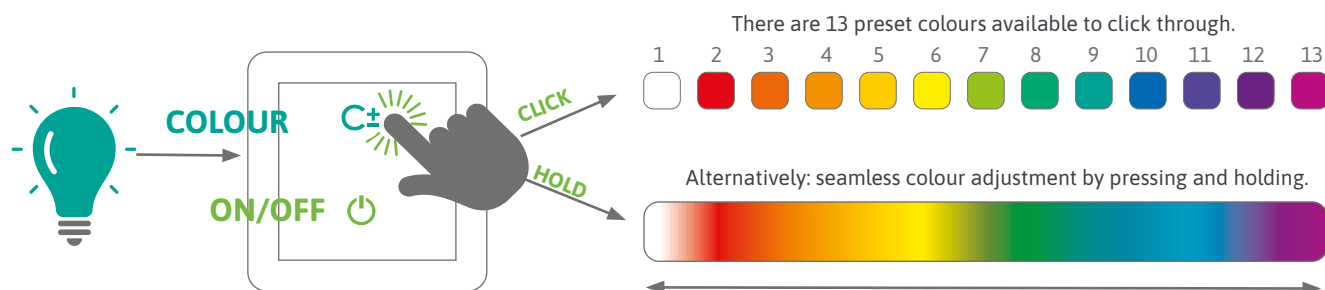

2) Dynamischer Modus – RGB-PLAY: Das Licht übernimmt.

In dynamic mode, the light moves on its own – creating smooth, automatic colour transitions across the full RGB spectrum. The changes are soft, organic, and emotionally engaging – perfect for an atmosphere that's always evolving.

You set the pace:

Lively – 5 seconds per colour

Balanced – 30 seconds per change

The RGB-PLAY mode brings your lighting to life – without you having to lift a finger.

Intuitive control – wireless and reliable.

The system is operated via wireless PushPower switches – stylish in design, precise in action.

With up to 10 linkable switches, your control remains flexible.

Thanks to the integrated memory function, your favourite scene is instantly restored the next time you turn on the lights.

SIRO RGB – Light that shows colour. Ambience that lasts.



PUSHPOWER

Key Features at a Glance

PUSHPOWER
WIRELESS & BATTERY FREE

Pairing the Control (Switch) with the Receiver

How to establish communication between the switch and your receiver:

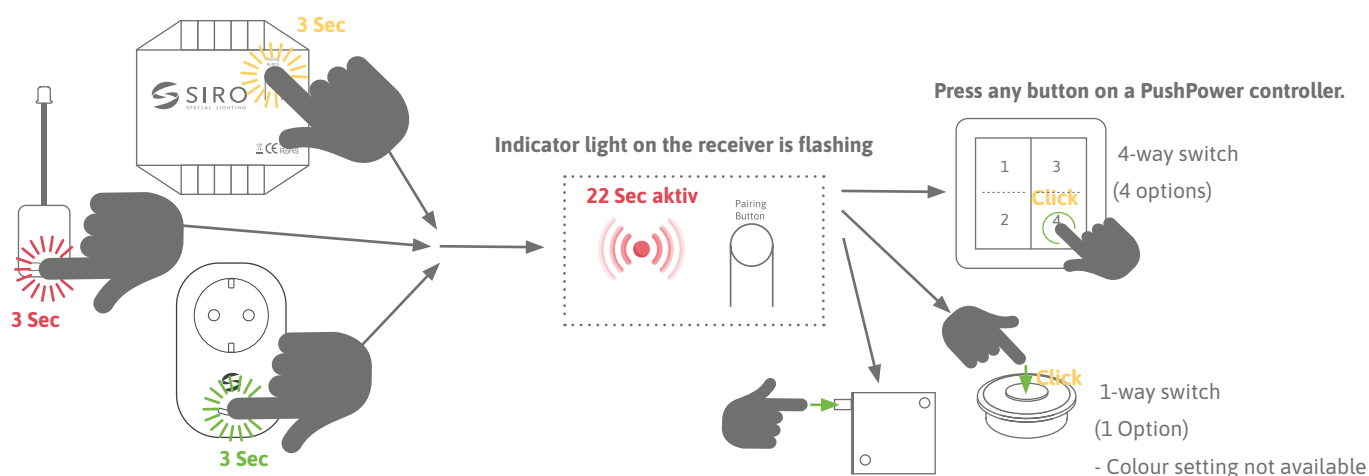

Press and hold for 3 seconds – the light begins to flash (heartbeat effect).

The pairing mode remains active for 22 seconds. After that, the process is cancelled, and the light switches off. The pairing process can also be cancelled by disconnecting the power. Each button/option (1 & 2) can be assigned its own function. If left unassigned, the button will remain inactive (blank function).



Activating the first button (Option 1) assigns it as the ON/OFF switch, and the opposite button (Option 2) is automatically assigned as the colour control. When multiple switches are activated, they function as toggle switches (multi-way switching).



MEMORY FUNCTION

The RGB PushPower receivers are equipped with a convenient memory function.

After switching off – whether via the switch or due to power loss – the system remembers the last selected colour and brightness.

The next time it's switched on, the exact same lighting mood is automatically restored – with no need to readjust.

Resetting the Receiver / Factory Default

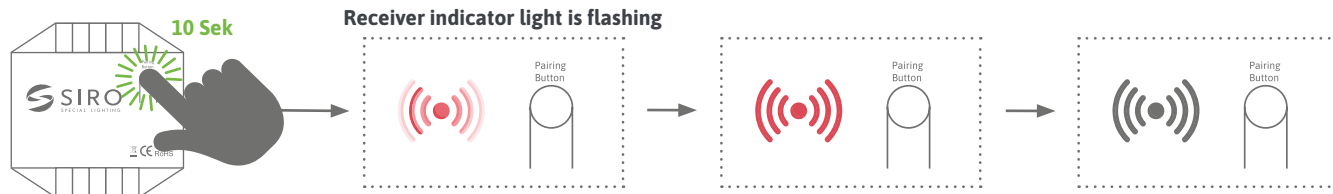

Hold for 10 seconds to clear all existing connections. The receiver is now ready to be paired again.

To reset the RGB PushPower receiver, press and hold the pairing button on a connected PushPower receiver for 10 seconds.

After this time, all existing connections will be cleared, and the receiver will return to factory default settings.

It is now ready to be paired with new switches or control devices – ideal for system changes or a complete reconfiguration.



2 MODI:

1) STATIC MODE (Quick press of the ON/OFF button when the light is off):

You select a specific colour – either from 13 predefined shades or seamlessly via button press. The chosen colour remains constant until you decide to change it. After the pairing process, the receiver automatically starts in Static Mode when the ON/OFF button is pressed.

Dimming:

A long press on the ON/OFF function button while the light is on is used to continuously increase or decrease brightness. This allows for precise adjustment of the lighting to suit personal preferences.

The switch opposite the paired ON/OFF switch is automatically assigned as the colour selector. It starts at white light or the most recently selected colour level (thanks to the memory function).

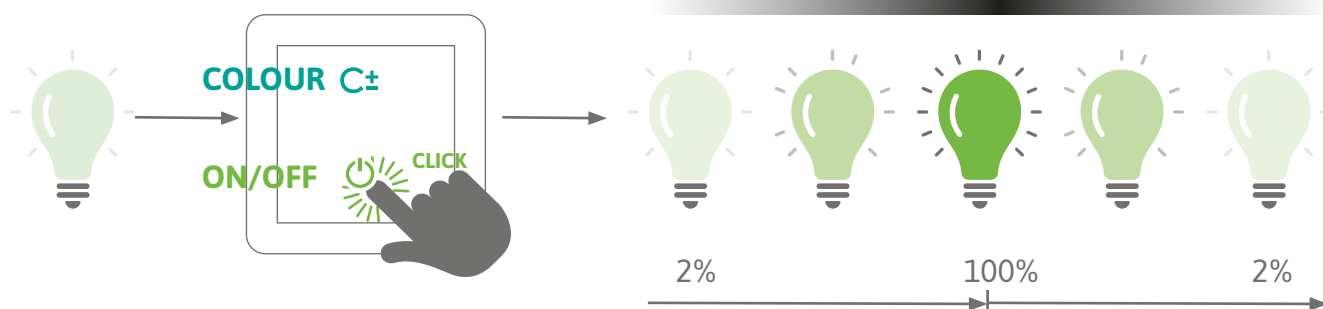

Static Mode – Colour Selection:

You can cycle through 13 preset colours at the touch of a button.

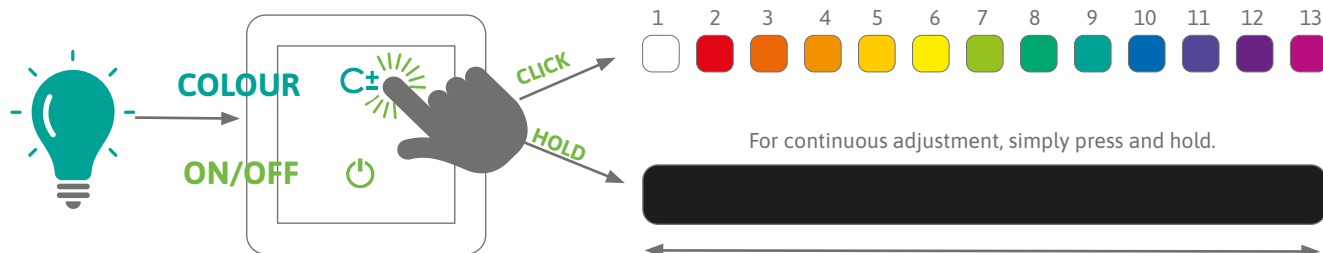

For continuous adjustment, simply press and hold.

- | | |
|--|--|
| <input type="checkbox"/> 1- WEISS | <input type="checkbox"/> 8- GRÜN |
| <input type="checkbox"/> 2- ROT | <input type="checkbox"/> 9- BLAUGRÜN |
| <input type="checkbox"/> 3- ROTORANGE | <input type="checkbox"/> 10- BLAU |
| <input type="checkbox"/> 4- ORANGE | <input type="checkbox"/> 11- BLAUVIOLETT |
| <input type="checkbox"/> 5- GELBORANGE | <input type="checkbox"/> 12- VIOLETT |
| <input type="checkbox"/> 6- GELB | <input type="checkbox"/> 13- ROTVIOLETT |
| <input type="checkbox"/> 7- GELBGRÜN | |

Press and hold the ON/OFF switch for 2 seconds while the light is off to start dynamic mode.



2) DYNAMIC MODE (Long press on ON/OFF switch while the light is off)

The light automatically cycles through colours – smoothly and gradually across the full RGB spectrum. The speed of the transitions can be individually adjusted.

After the pairing process, the receiver automatically starts in Static Mode.

To activate Dynamic RGB-PLAY Mode, press and hold the ON/OFF switch for two seconds while the light is off. This mode initiates an automatic colour flow between red, green, and blue.

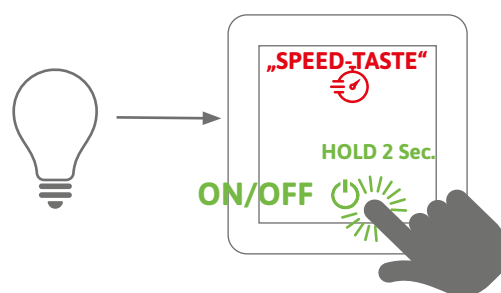

DIMMING: A long press on the ON/OFF function button while the light is on enables seamless brightness adjustment – either increasing or decreasing the light intensity smoothly. This allows for precise customisation of the lighting to suit personal preferences.

DYNAMISCHER MODUS GESCHWINDIGKEITSEINSTELLUNG:

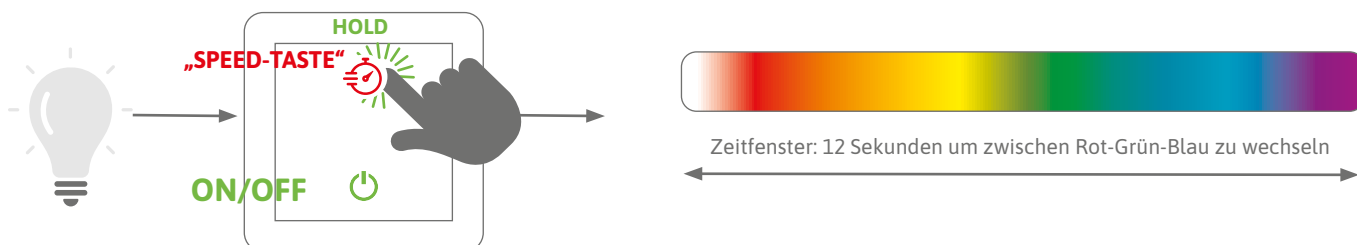

The RGB-PLAY mode offers three speed levels for dynamic colour transitions. The available speed settings per colour interval are:

5 seconds / 30 seconds/ 2 minutes

By pressing and holding the “Speed” button, the transition speed adjusts continuously from 5 seconds up to 120 seconds, and then reverses back – providing smooth, step-free control.

Additional Details:

The first activation of the Speed button always begins with a 5-second interval and starts with red light. This ensures correct synchronisation across multiple receivers. With each press-and-hold action, the adjustment direction reverses – for example, from increasing to decreasing speed.

You have a 7-second window to make adjustments to the speed setting during the hold.

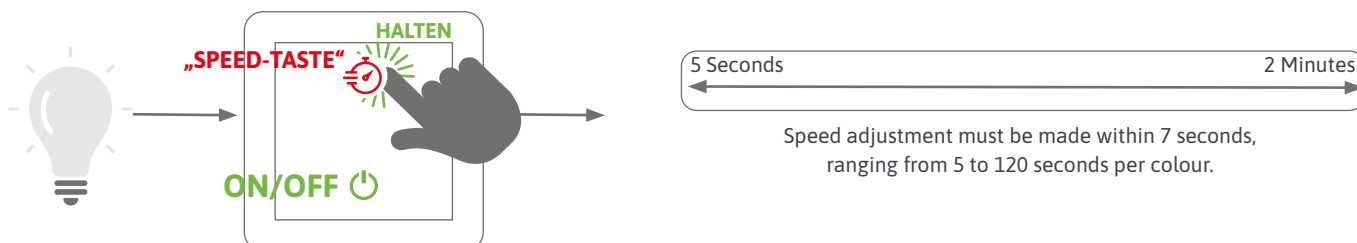

RECEIVER

RGB RECEIVER

RGB Receiver SL-PPREC01RGB

The SIRO RGB Receiver SL-PPREC01RGB provides convenient control of your SIRO RGB LED lights – with on/off switching, continuous Dimming and a memory function that saves your last light setting. Thanks to the radio-based range of up to 30 meters and the ability to connect multiple switches offers maximum flexibility.

PRODUCT FEATURES

- ▶ 12 - 48V DC RGB receiver as receiver for push power switch
- ▶ Ready to plug in for connecting SIRO RGB LED lights
- ▶ Up to 10 switching buttons (2 or 4-way switches) or Switch components are connected
- ▶ Radio-based range up to 80 meters in open terrain
- ▶ Functions: ON - OFF - DIM - RGB Color - Dynamic Color Change
- ▶ Product has a memory function (last light setting)

ASSEMBLY

- ▶ The product can be glued or individually placed

DIMENSIONS

- ▶ Housing Dimensions (LxDxH): 52 x 52 x 23 mm
- ▶ Dimensions of distribution box (LxWxH): 55,5 x 33 x 10 mm

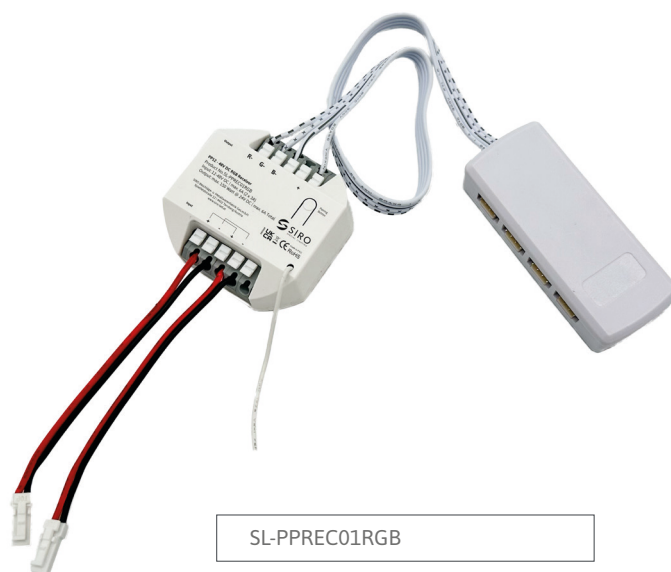

SL-PPREC01RGB

TECHNICAL DRAWING

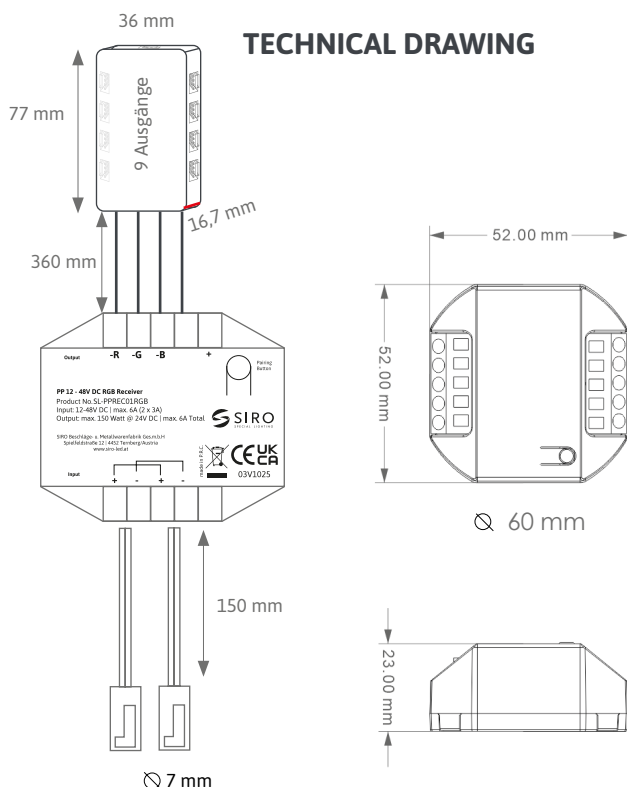

TECHNICAL FEATURES

- ▶ Transmission protocol: RF 433 mhz
- ▶ RF Range: 30 meters (in buildings)
- ▶ IP Rating: IP20
- ▶ Input: 12 - 48V DC, 2 x 150 mm connection cable (AWG 20) with SIRO plug (each plug 3A = max 72 Watt @24V DC)
- ▶ Output power: 144 Watt @ 24V DC, 1 x 150 mm with 9-way distribution box 3A per connection = 72 Watts @ 24V DC 6A Total = 144 Watts @ 24V DC
- ▶ Standby Power: ≤ 1W
- ▶ Receiver Sensitivity: -110dBm
- ▶ Dimming method: PWM 1000 Hz
- ▶ Operating temperature: 0°C to 55°C

FLEXLINE 612

15 WATTS

FLEXLINE 612 - SILICONE PROFILE WITH SIRO RGB DIAMOND PRO

DIAMOND PRO SERIES

- ▶ Silicone profile 6 x 12 mm with SIRO RGB DIAMOND PRO 15 watts/m
- ▶ 500 mm soldered connection cable with SIRO RGB connector
- ▶ Protection class: IP 20 (can be sealed with silicone at both ends to IP 67)
- ▶ Controllable and dimmable with SIRO RGB Receiver
- ▶ The specified lengths refer to the silicone profile!
- ▶ The length of the light source contained therein can vary!
- ▶ Pitch: 25 mm
- ▶ **Installation recommendation:**
Guide values for groove: Width: 5.9 to 6.1mm, Depth: 11.9 to 12.1mm
Due to the complex manufacturing process of extruded silicone products, we recommend a test cut/trial milling before processing to determine the optimal cutting width/cutting depth.



Article No.	LED/M	Light color	Width x Height	length	Volt	IP	Watt/M
SL-FL-DP-RGB15W-*	280	RGB	6 mm x 12 mm	450 mm 600 mm 900 mm 1200 mm 1500 mm 2000 mm 2500 mm 3000 mm 5000 mm	24	20 /67	15
SL-FLEX-KL1206-SET1	Mounting clips		8 mm x 14 mm		10 pieces including mounting screws		

*Composition of the article number - e.g.: SL-FL-DP-RGB15W in 1200 mm = Art.No. SL-FL-DP-RGB15W-1200

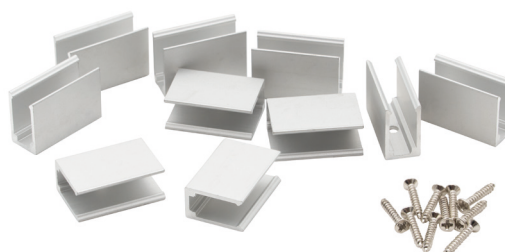
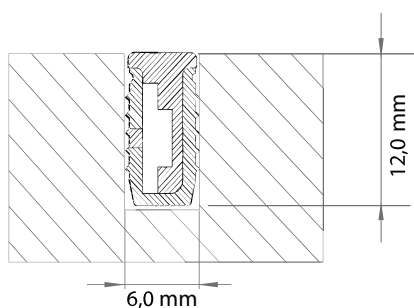

Article No.

SL-FLEX-KL1206-SET1

RGB DIAMOND PRO 8MM

15 WATTS

RGB DIAMOND PRO 8MM

Slim, powerful, brilliant – the RGB DIAMOND PRO strip is the perfect choice for demanding color lighting applications in tight spaces. At just 8 mm wide, it fits effortlessly into delicate profiles and compact installations – without compromising on light output or color depth.

The high-quality RGB components deliver rich colors and uniform illumination along the entire length. Ideal for accent lighting, display cases, or subtle ambient moods. Combined with a suitable heat sink (e.g., One4all profile), the RGB strip maintains long-lasting performance and color stability. Whether in commercial or residential settings – this strip impresses with its compact design, easy handling, and striking color effects.

- ▶ Universally applicable, easy processing
- ▶ Width: 8 mm, Length: 5000 mm
- ▶ Pitch: 25 mm
- ▶ 24 V DC - 15 watts / meter - SMD chip
- ▶ 280 LED per meter, 350 lumens per meter
- ▶ IP 20 (indoor)
- ▶ Color temperature: RGB colors
- ▶ 500 mm connection cable at both ends
- ▶ Maximum recommended length for one-sided feed: 5 m
- ▶ can be used with FLEXLINE 612 as a light source

DIAMOND PRO SERIES



15
Watt

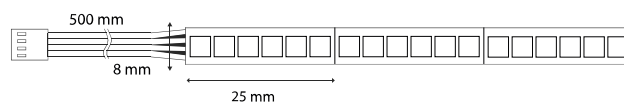

Connect LED strip

The SIRO strips can be contacted at any point using solder or express clip connections.

Article No.	LED/M	Light color	Width	Length	Lumen	Cut	Volt	IP	Watt/M
SL-2RGB8DP15W-5MA	280	RGB colors	8 mm	5000	350	25 mm	24	20	15

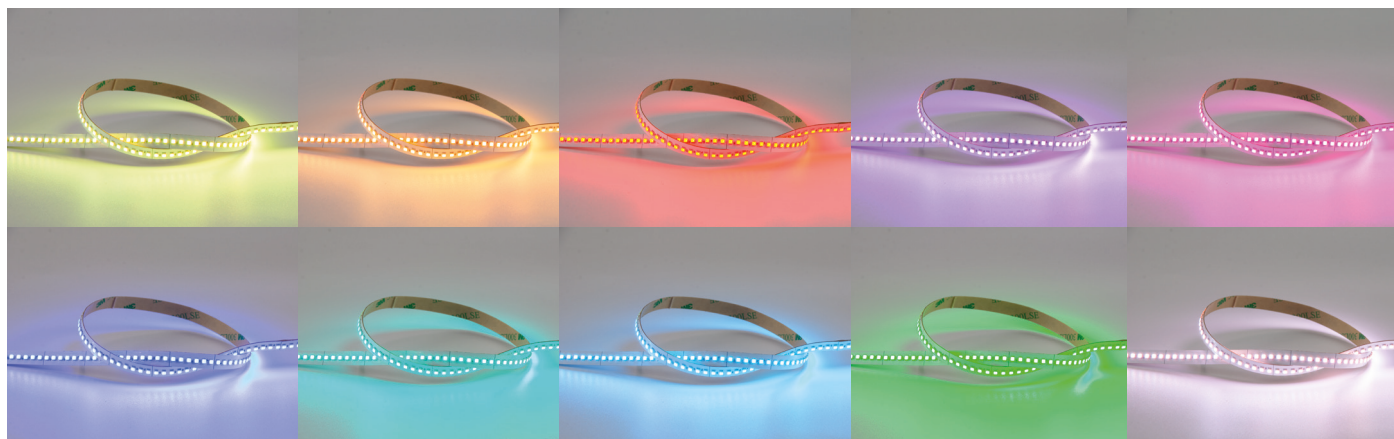

Composition of the article number - e.g.: SL-2D8RP15W2260- in 5000 mm = SL-2D8RP15W2260-5MA

RGB VIPER 8MM

15 WATTS

RGB VIPER 8MM

When color meets performance, the RGB VIPER LED strip is the top choice for dynamic lighting design. Equipped with powerful RGB chips, it creates brilliant color accents or atmospheric lighting moods – perfect for modern interiors, display cases, or ambient lighting. CSP technology ensures a consistently homogeneous light line without any visible light points – ideal for exposed applications.

Thanks to innovative 4-pin RGB technology, countless color combinations can be achieved – from smooth gradients to bold effects. For optimal performance, we recommend using a cooling profile (e.g., One4all) to ensure long-lasting durability and color brilliance. Whether in residential spaces, retail environments, or hospitality settings – the RGB VIPER LED strip stands for vivid colors, uniform illumination, and effortless integration.

- ▶ Pitch: 25 mm
- ▶ universally applicable, easy processing
- ▶ adhesive
- ▶ Width: 8 mm
- ▶ Length: 5000 mm
- ▶ Maximum recommended length for one-sided feed: 5 m
- ▶ 24V DC - 15 Watt / Meter - CSP Chip
- ▶ 280 LEDs per meter
- ▶ IP 20 (indoor)
- ▶ Color temperature: RGB color space with 13 preset colors.

15
Watt

VIPER
LED SERIES



Article No.	LED/M	Light color	Width	length	Lumen	Cut	Volt	IP	Watt/M
SL-2RGB8RP15W-5MA	280	RGB	5 mm	5000 mm	350	25 mm	24	20	15



SPOT

12 WATTS

RGB RECESSED SPOTLIGHT

- ▶ swiveling recessed spotlight with interchangeable frame
- ▶ 500 mm soldered connection cable with SIRO RGB connector
2000 mm extension cable
- ▶ Protection class: IP 44
- ▶ Controllable and dimmable with SIRO RGB Receiver
- ▶ Installation diameter: 81 - 84 mm
- ▶ Installation depth: 56 mm (without spring)
- ▶ Ceiling thickness: 1 - 40 mm
- ▶ Cover frame round or square not included in the product
- ▶ **Installation recommendation:**
Spot can be used in ceilings (drywall)



12
Watt

Article No.	Light color	Diameter x height	Lumen	Volt	IP	Watt/M
SL-SPOT04-RGB12W	RGB	96 x 56 mm	216	24	44	12

ROUND COVER

- ▶ Round cover frame for SPOT04
- ▶ Diameter: 96 mm
- ▶ Ring height: 4 mm



Article No.	Frame color
SL-SPOT04CH1-PB12	black
SL-SPOT04CH1-PB32	matt white
SL-SPOT04CH1-ZN1	shiny chrome-plated
SL-SPOT04CH1-ZN5	gold
SL-SPOT04CH1-ZN21	nickel-plated, finely ground

SQUARE COVER

- ▶ Square cover frame for SPOT04
- ▶ Length x Width: 96 mm
- ▶ Ring height: 4 mm

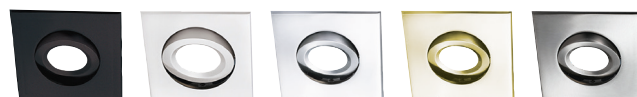

Article No.	Frame color
SL-SPOT04CH2-PB12	black
SL-SPOT04CH2-PB32	matt white
SL-SPOT04CH2-ZN1	shiny chrome-plated
SL-SPOT04CH2-ZN5	gold
SL-SPOT04CH2-ZN21	nickel-plated, finely ground

RGB ACCESSORIES



Extension Cable 2000 mm

- ▶ Extension cable 2000 mm with SIRO RGB plug
- ▶ Max. 3A (72 Watts @ 24V DC)

Article No.	Item description
SL-CAB4-EXT-2000	2000 mm extension cable



Y-Distributor

- ▶ 300 mm cable with SIRO RGB connector
- ▶ Total: Max. 3A (72 Watt @24V DC)
- ▶ Max. 3A per connection

Article No.	Item description
SL-CAB4-VER2-300	Y-Distributor

POWER SUPPLY

24 VDC

- ▶ Power supply for LED lamps with constant voltage (24 VDC)
- ▶ Protection class 2 against electric shock through direct & indirect contact
- ▶ IP 20 - suitable for indoor use
- ▶ Interruption, short circuit, overload and overheating protection
- ▶ Standby 36 watts < 0.13 W / 60 watts < 0.32 / 100 watts < 0.21
- ▶ 2000 mm connection cable with detachable Euro plug (230V AC)
- ▶ Output: Maximum load per slot: 3A



INPUT: 2000 mm connection cable with detachable Euro plug for the 230 VAC power grid



**36
Watt**

Article No.	Dimensions in mm (LxWxH)	Power
SL-NTS24CV36W-CA	112 x 39,1 x 18	36 Watts

OUTPUT: up to 4 x 24V DC LED lights or SIRO receiver (max 3 A per connection)



**60
Watt**

Article No.	Dimensions in mm (LxWxH)	Power
SL-NTS24CV60W-CA	172 x 62 x 19	60 Watts

OUTPUT: up to 5 x 24V DC LED lights or SIRO receiver (max 3 A per connection)



**100
Watt**

Article No.	Dimensions in mm (LxWxH)	Power
SL-NTS24CV100W-CA	201,3 x 71,20 x 18	100 Watts

OUTPUT: up to 8 x 24V DC LED lights or SIRO receiver (max 3 A per connection)



- ▶ Constant voltage power supply (24 VDC)
- ▶ Protection class 2 against electric shock through direct & indirect contact
- ▶ 6-way distribution box with 250 mm connection cable for SIRO receiver
- ▶ Interruption, short circuit, overload and overheating protection
- ▶ Standby < 0.3W
- ▶ 2000 mm connection cable with 90° angled Euro plug (230 VAC)
- ▶ IP 20 - suitable for indoor use
- ▶ Output: Maximum load per slot: 3A



INPUT: 2000 mm connection cable with 90° angled Euro plug for the 230 VAC power supply



OUTPUT: 6-way distribution box for connecting SIRO receivers (max. 3A per connection, total: 6A)

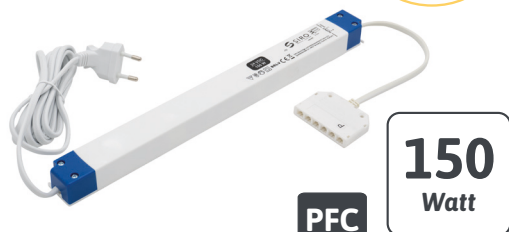

Article No.	Dimensions in mm (LxWxH)	Power
SL-NT24CV150W-DB1	322,6 x 30 x 21,5	150 Watt

PFC Power factor correction filter integrated in SIRO power supplies



Seamlessly Integrate Floor Lamps & Ambient Lighting
PUSHPOWER WIRELESS SOCKET

SL-PPREC01AC-K60



POWER SUPPLY

WHICH POWER SUPPLY IS REQUIRED?

A power supply converts 230V AC into low DC voltage, which is used by electronic devices. It is the heart of many electrical systems, because without a reliable power supply, even the best circuits cannot deliver their full performance.

A well-dimensioned designed power supply ensures efficient energy supply that is perfectly tailored to the needs of the system.

1) Connect the power supply: Connect the power supply to a suitable power source (wall socket). Make sure that the socket and the power supply cable meet the technical requirements.

2) Voltage adjustment: DSize the power supply appropriately for the light sources used. For optimal and long-lasting use our power supplies, we recommend dimensioning the power supply up to 10% larger than the calculated system power. The sum of the specified connected devices should therefore be approximately **10% below the maximum load** of the power supply/receiver.

3) Safety measures: The power supply should be protected from moisture and located in a well-ventilated area.

CALCULATION EXAMPLE

Example 1:

For one project, we're using three 11 watt/m SL-2M8C11W27-5MA LED strips (1 x 2.2 m and 2 x 0.9 m).

$$1 \times 2,2\text{m} \rightarrow 2,2 \times 11 = 24,2 \text{ Watts}$$

$$2 \times 0,9\text{m} \rightarrow (0,9+0,9) \times 11 = 19,8 \text{ Watts}$$

$$\text{Calculated system power} \quad \underline{\underline{44,0 \text{ Watts}}}$$

$$+10\% \text{ system buffer } (44 \times 1,10) \rightarrow \underline{\underline{48,4 \text{ Watts}}}$$

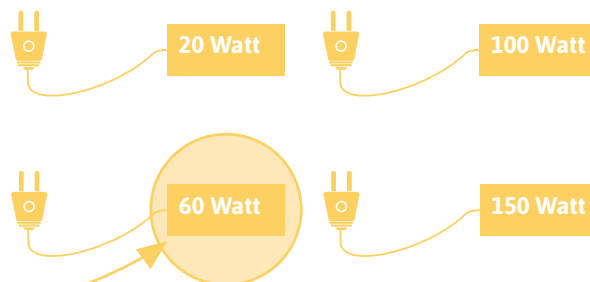

For a long product lifespan, we recommend a 60-watt power supply, e.g., SL-NT24CV60W-DB1.

Example 2:

We use three recessed spotlights SL-SPOT06-DUO3W with 2.5 watts and two 2.6 m LED strips SL-2M8C11W27-5MA with 11 watts/m

$$3 \times 2,5 \text{ Watts} = 7,5 \text{ Watts}$$

$$2 \times 2,6\text{m} \rightarrow 5,2 \times 11 = 57,2 \text{ Watts}$$

$$\text{Calculated system power} \quad \underline{\underline{64,7 \text{ Watts}}}$$

$$+10\% \text{ system buffer } (51,5 \times 1,10) \rightarrow \underline{\underline{71,17 \text{ Watts}}}$$

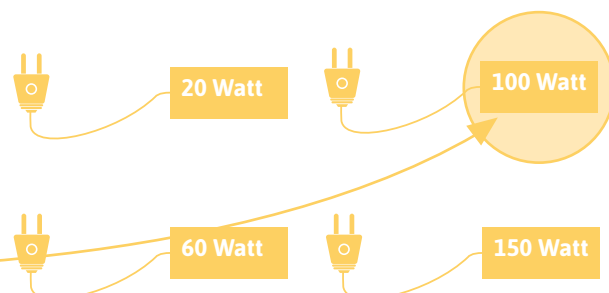

For a long product lifespan, we recommend a 100-watt power supply. e.g.: SL-NT24CV100W-DB1

WIRED SENSORS

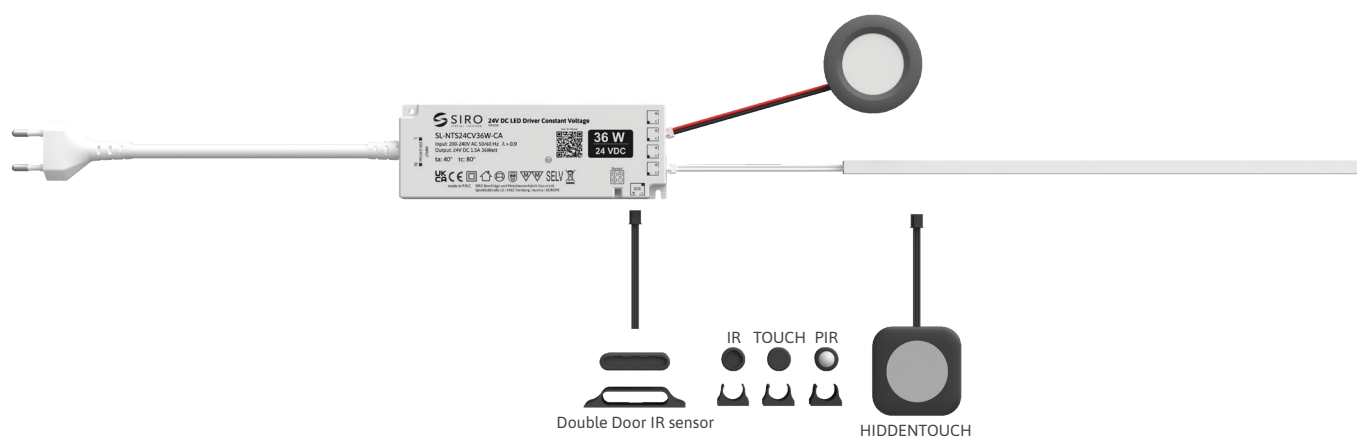

Motion-Sensor

Touch-Sensor for Furniture

Hidden Capacitive Touch sensor



SL-NBSP12-K1



SL-NBSTOUCH12-K1



SL-NBSHTOUCH50-A158

**IR-Sensor
for Hinged Doors and Drawers**

**IR-Sensor for
Double Hinged Doors and Drawers**



SL-NBSDOOR12-K1



SL-NBSDOOR58-K1



WIRED SENSORS

PIR SENSOR

MOTION SENSOR



Article No.

SL-NBSP12-K1

Take advantage of the SL-NBSP12-K1 and make your lighting smarter and more efficient!

PRODUCT FEATURES

- ▶ wired motion sensor
- ▶ Connection to SIRO24V DC power supplies (p.42) SL-NTS24CV36W-CA, SL-NTS24CV60W-CA, SL-NTS24CV100W-CA
- ▶ Sensor can be screwed on or milled in
- ▶ Turns light ON-OFF
- ▶ Reaction range: 0 - 2 m (120° detection angle)
- ▶ Lighting duration: 30 seconds
- ▶ Scope of delivery: including 2000 mm connection cable

PERFECT SOLUTION:

Ideal for hallways, stairwells, and entryways, the SL-NBSP12-K1 offers reliable automatic light control. It also ensures that the night light at the edge of the bed switches on gently and dimly if you need to get up again in the middle of the night. The sensor thus guarantees optimal comfort and safety at all times.

SPECIAL FEATURE:

The head can be removed, which allows for easy maintenance.

ASSEMBLY

- ▶ Milling, screwing or gluing
- ▶ Placing the sensor on the door fitting side is recommended
- ▶ When milling, please refer to the technical milling diagram

Milling depth: 18 mm

Milling diameter: 12 mm





TECHNICAL DRAWING

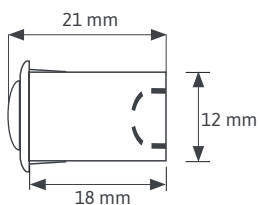
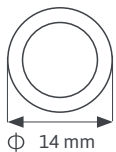
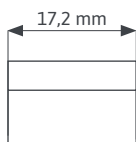
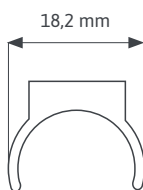

DIMENSIONS

- ▶ Sensor including Housing (LxDxH): 21 x 18,2 x 14 mm

TECHNICAL FEATURES

- ▶ Input voltage 12-24V AC
- ▶ Output voltage 24V DC

SAFETY AND ASSEMBLY INSTRUCTIONS

- ▶ This product is not a toy and is not suitable for children
- ▶ The SIRO LED system is designed for indoor use
- ▶ Unprotected outdoor use is not permitted
- ▶ Contact with moisture must be avoided at all costs

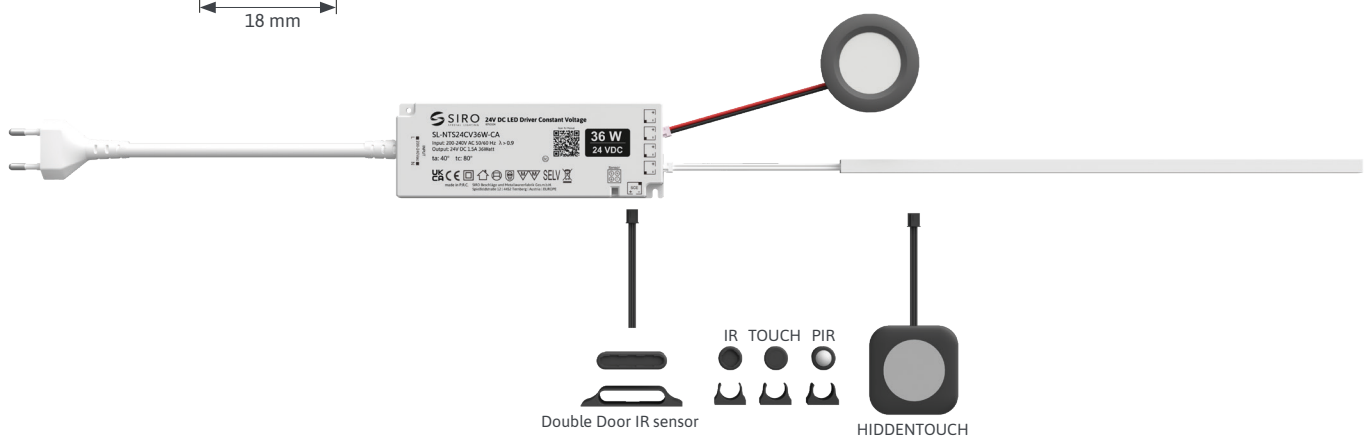

WIRED SENSORS

TOUCH SENSOR

TOUCH SENSOR FOR FURNITURE



Article No.

SL-NBSTOUCH12-K1

The discreet touch sensor is perfect for unobtrusive integration into any piece of furniture. Its minimal dimensions keep your design stylish and uncluttered while maintaining full light control.

PRODUCT FEATURES

- ▶ wired touch sensor
- ▶ Connection to SIRO24V DC power supplies (p.42) SL-NTS24CV36W-CA, SL-NTS24CV60W-CA, SL-NTS24CV100W-CA
- ▶ Sensor can be screwed on or milled in
- ▶ Turns light ON-OFF and can dim
- ▶ Switching command by touching the sensor surface
- ▶ Scope of delivery: including 2000 mm connection cable

PERFECT SOLUTION:

Ideal for controlling wired light sources..

SPECIAL FEATURE:

The head is removable, allowing for easy maintenance. The SL-NBSTOUCH12-K1 is the ideal choice for those who value functionality and want to harmonize aesthetics.

ASSEMBLY

- ▶ Milling, screwing or gluing
 - ▶ Placing the sensor on the door fitting side is recommended
 - ▶ When milling, please refer to the technical milling diagram
- | | |
|-------------------|-------|
| Milling depth: | 18 mm |
| Milling diameter: | 12 mm |



TECHNICAL DRAWING

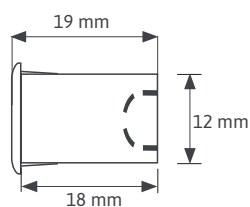
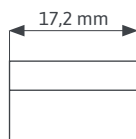
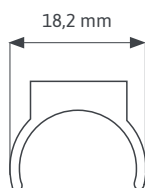

DIMENSIONS

- ▶ Sensor including housing (LxDxH): 21 x 18,2 x 16 mm

TECHNICAL FEATURES

- ▶ Input voltage 12-24V AC
- ▶ Output voltage 24V DC

SAFETY AND ASSEMBLY INSTRUCTIONS

- ▶ This product is not a toy and is not suitable for children
- ▶ The SIRO LED system is designed for indoor use
- ▶ Unprotected outdoor use is not permitted
- ▶ Contact with moisture must be avoided at all costs

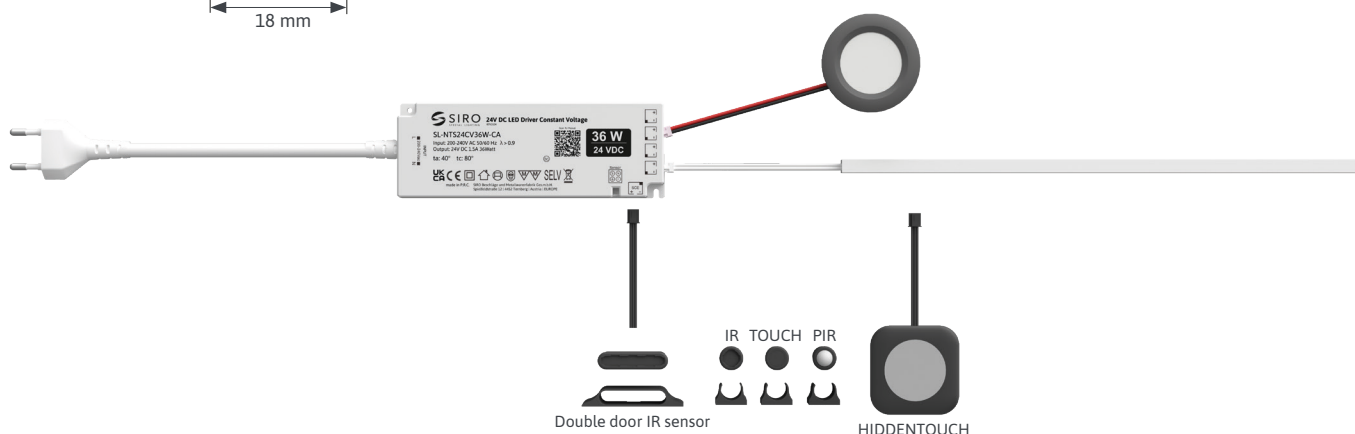

WIRED SENSORS

DOOR SENSOR

IR-SENSOR FOR REVOLVING DOORS AND DRAWERS



Article No.

SL-NBSDOOR12-K1

The elegant proximity sensor can be discreetly integrated into any piece of furniture. Its compact design allows for a clean and stylish aesthetic while providing optimal lighting control.

PRODUCT FEATURES

- ▶ wired touch sensor
- ▶ Connection to SIRO24V DC power supplies (p.42) SL-NTS24CV36W-CA, SL-NTS24CV60W-CA, SL-NTS24CV100W-CA
- ▶ Sensor can be screwed on or milled in
- ▶ Turns light ON-OFF and can dim
- ▶ Reaction range: 0 - 60 mm
- ▶ Scope of delivery: including 2000 mm connection cable

PERFECT SOLUTION:

Ideal for controlling wired light sources.

SPECIAL FEATURE:

Thanks to its simple wired installation, the sensor reliably turns the light on and off upon approach. The SL-NBSDOOR12-K1's exceptional flexibility allows for effortless maintenance, as the sensor head can be easily unplugged and replaced.

ASSEMBLY

- ▶ Milling, screwing or gluing
 - ▶ The placement of the sensor on the door fitting side or on the drawer back of the shop is recommended
 - ▶ When milling, please refer to the technical milling diagram
- | | |
|-------------------|-------|
| Milling depth: | 18 mm |
| Milling diameter: | 12 mm |



TECHNICAL DRAWING

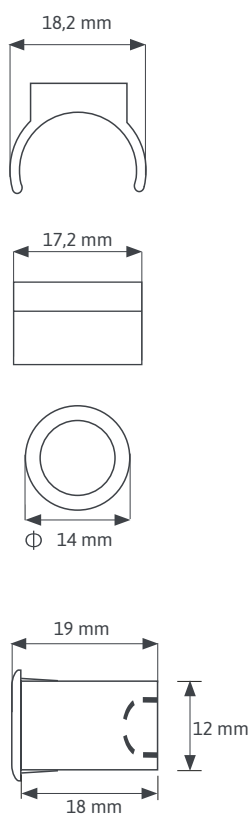

DIMENSIONS

- ▶ Sensor including housing (LxDxH): 21 x 18,2 x 16 mm

TECHNICAL FEATURES

- ▶ Input voltage 12-24V AC
- ▶ Output voltage 24V DC

SAFETY AND ASSEMBLY INSTRUCTIONS

- ▶ This product is not a toy and is not suitable for children
- ▶ The SIRO LED system is designed for indoor use
- ▶ Unprotected outdoor use is not permitted
- ▶ Contact with moisture must be avoided at all costs

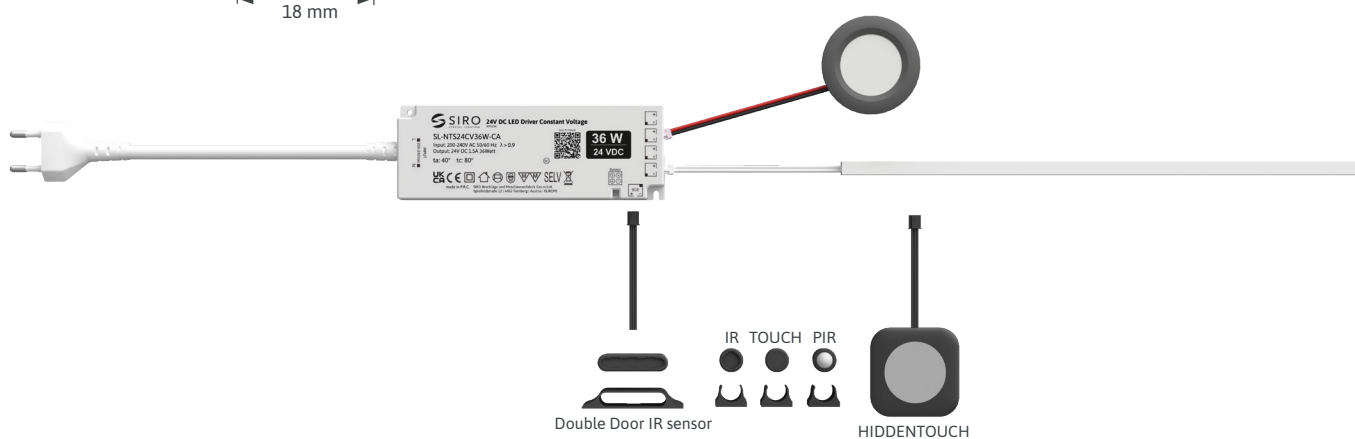

WIRED SENSORS

DOUBLE DOOR SENSOR

IR-SENSOR FOR DOUBLE HINGED DOORS AND DRAWERS



Article No.

SL-NBSDOOR58-K1

Maximum flexibility and reliability: Our SIRO SL-NBSDOOR58-K1 switches the light on when a reaction range of 0 - 60 mm and is ideal for stylish double door solutions.

PRODUCT FEATURES

- ▶ Wired double door sensor for connection to SIRO24V DC power supplies (p. 42) SL-NTS24CV36W-CA, SL-NTS24CV60W-CA, SL-NTS24CV100W-CA
- ▶ Sensor can be screwed on or milled in
- ▶ Turns light ON-OFF
- ▶ Reaction range: 0 - 60 mm
- ▶ Scope of delivery: including 2000 mm connection cable

PERFECT SOLUTION:

Ideal for controlling wired light sources on double doors.

SPECIAL FEATURE:

Discover the SL-NBSDOOR58-K1: A wired proximity sensor for double doors that stands out with its easy installation and precise switching. Perfect for modern furniture and innovative designs.

ASSEMBLY

- ▶ Milling, screwing or gluing
 - ▶ Placing the sensor on the door fitting side is recommended
 - ▶ When milling, please refer to the technical milling diagram
- | | |
|-----------------|-------|
| Milling depth: | 24 mm |
| Milling height: | 8 mm |
| Milling width: | 38 mm |



TECHNICAL DRAWING

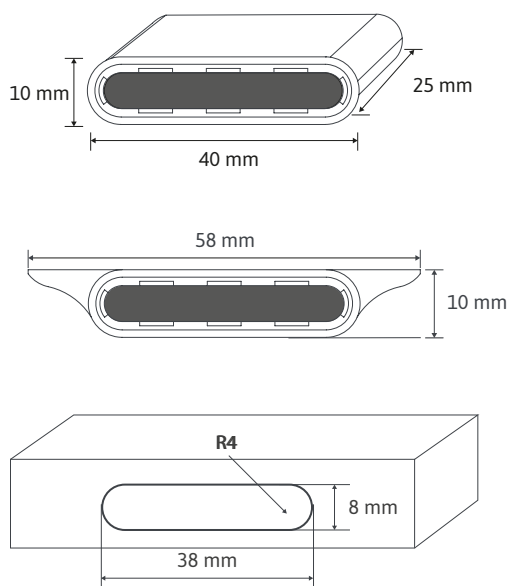

DIMENSIONS

- ▶ Sensor including Housing (LxDxH): 58 x 24 x 10 mm

TECHNICAL FEATURES

- ▶ Input voltage 12-24V AC
- ▶ Output voltage 24V DC

SAFETY AND ASSEMBLY INSTRUCTIONS

- ▶ This product is not a toy and is not suitable for children
- ▶ The SIRO LED system is designed for indoor use
- ▶ Unprotected outdoor use is not permitted
- ▶ Contact with moisture must be avoided at all costs

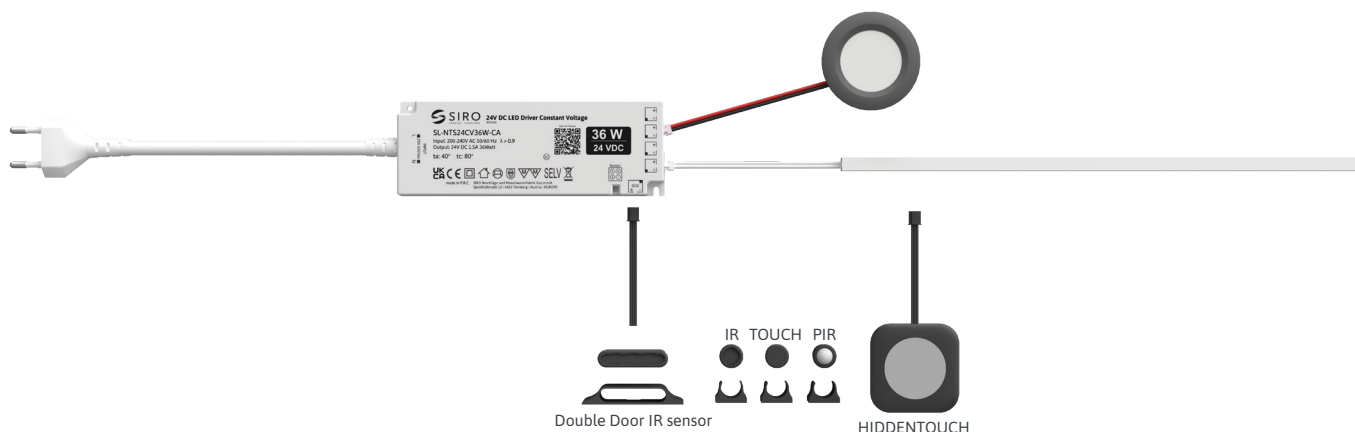

WIRED SENSORS

CAPACITIVE SENSOR

Hidden capacitive TOUCH-Sensor



Article No.

SL-NBSHTOUCH50-A158

APPLICATIONS:

- ▶ Desks: Switch light directly through the tabletop – no more annoying switches
- ▶ Kitchen counters: Perfect for stylish lighting, easy to control by touch
- ▶ Home furniture: Make your living room smarter – invisible and comfortable!

ASSEMBLY:

- ▶ Glue on or mill in if necessary

“Touch & Light: The new invisible touch sensor!”

With the wired SIRO touch sensor, any surface becomes a control center! Simply stick it on and The light is now controlled by touch. Ideal for desks, kitchen counters, or living room furniture. **Turns lights ON, OFF, and DIM** – without any visible switches.

Can be combined with our SIRO 24V DC power supplies.

PRODUCT FEATURES

- ▶ wired TOUCH-Sensor for connection to SIRO24V DC mains Parts: SL-NTS24CV36W-CA, SL-NTS24CV60W-CA, SL-NTS24CV100W-CA
- ▶ Sensor can be glued on or milled in if required
- ▶ Functional area through wood up to max. 20 mm
- ▶ Switches light ON-OFF-DIM
- ▶ Switching command by touching the capacitive surface
- ▶ Scope of delivery: including 2000 mm connection cable

PERFECT SOLUTION:

Ideal for controlling wired light sources on double doors.

SPECIAL FEATURES:

- ▶ Invisible control: No button, no remote control – simply touching the surface
- ▶ Easy installation: glue or mill
- ▶ Multifunctional: ON/OFF switching or dimming – all in one
- ▶ Flexible: With 2000 mm connection cable for maximum freedom



TECHNICAL DRAWING

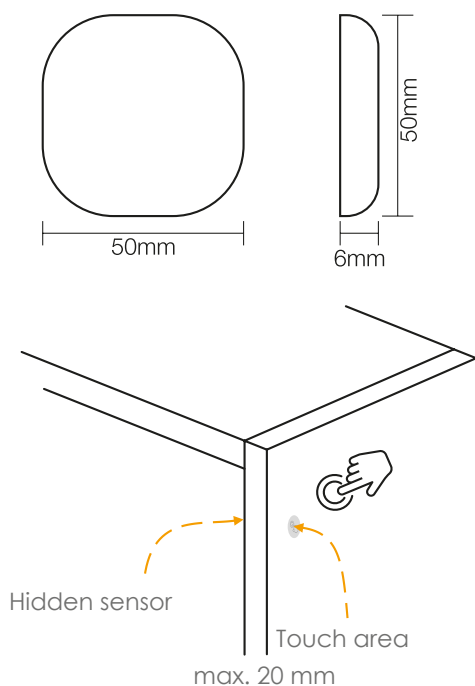

DIMENSIONS

- ▶ Sensor including Housing (LxDxH): 50 x 50 x 6 mm
- ▶ Cable length: 2000 mm
- ▶ Cable connection Diameter: 6,5 mm

TECHNICAL FEATURES

- ▶ Input voltage 24V DC
- ▶ Output voltage 24V DC
- ▶ Functional area through wood < 20 mm

SAFETY AND ASSEMBLY INSTRUCTIONS

- ▶ This product is not a toy and is not suitable for children
- ▶ The SIRO LED system is designed for indoor use
- ▶ Unprotected outdoor use is not permitted
- ▶ Contact with moisture must be avoided at all costs

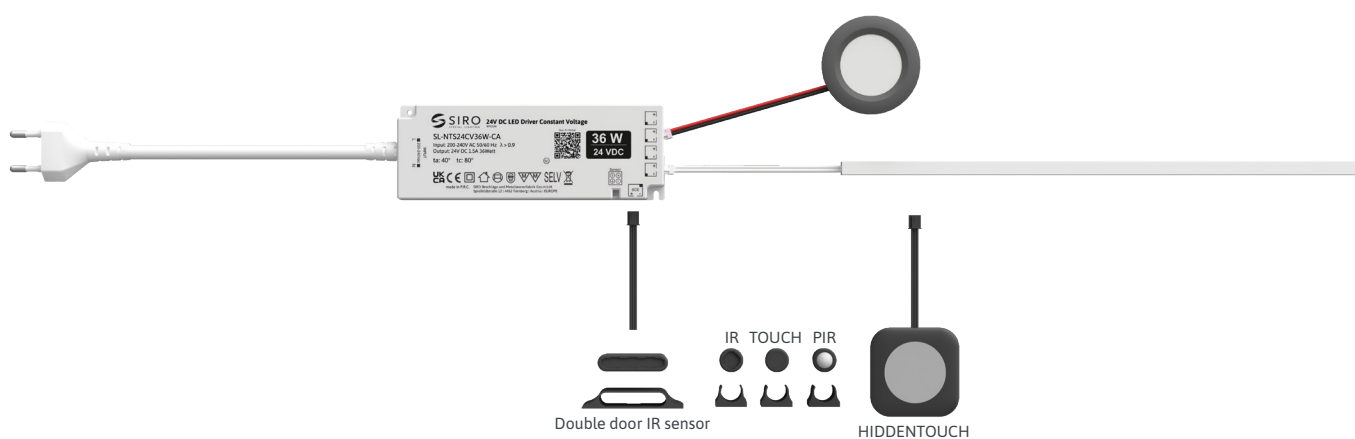

RECEIVER 230V AC



SWITCH | TRIAC | DIN RAIL

SWITCH: Manual switching on/off of 230V products with a simple Switch function



Article No.

SL-PPREC02SWITCH

TRIAC: Stepless dimming of 230V products for precise lighting control



Article No.

SL-PPREC02TRIAC

CONNECTION PLAN

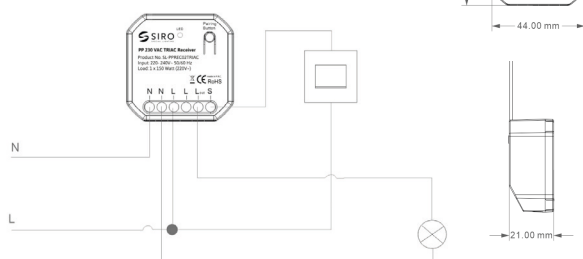

PRODUCT FEATURES

- ▶ 230V AC MONO TRIAC Receiver as receiver for push power switches
- ▶ Connection of dimmable LED capable lights based on 230V AC.
- ▶ Up to 10 switching buttons (2 or 4-way switches) or Switch components are connected
- ▶ Radio-based range up to 80 meters
- ▶ Functions: ON - OFF - DIM
- ▶ Product has a memory function (last light setting)
- ▶ Repeater Mesh function to activate & deactivate

ASSEMBLY

- ▶ In device box according to DIN 49073, in the luminaire (ceiling lights), individual placement
- ▶ Installation may only be carried out by qualified electricians

DIMENSIONS

- ▶ Housing dimensions (LxDxH): 44 x 44 x 21 mm

TECHNICAL FEATURES

- ▶ Transmission protocol: RF 433 mhz
- ▶ Range (without mesh): 30 meters (in buildings)
- ▶ IP Rating: IP20
- ▶ Input voltage: 220 - 240V AC 50/60Hz
- ▶ Output power: 1 channel / 1.5 A
150 watts (~ 220V AC) - Led
- ▶ Standby Power: ≤ 1W
- ▶ Receiver Sensitivity: -110dBm
- ▶ Operating temperature: 0°C to 40°C
- ▶ Connection socket: 2,6 x 2 mm
- ▶ Cable cross-section: 2.5 mm² rigid cable/solid conductor
1.5 mm² stranded cable



Article No.

SL-PPREC01AC-K60

Wireless plug:

Wireless 230V control for flexible, quick and easy integration (e.g., of floor lamps, fans, and televisions)

PRODUCT FEATURES

- ▶ 230V AC MONO ON - OFF Receiver as receiver for push power switch
- ▶ Connection of 230V AC products up to a max. of 3680 watts power (~220V AC)
- ▶ Up to 10 switching buttons (2 or 4-way switches) or Switch components are connected
- ▶ Radio-based range up to 80 meters
- ▶ Functions: ON - OFF
- ▶ Repeater Mesh function to activate & deactivate

ASSEMBLY

- ▶ Adapter is plugged between 230V AC power connections

DIMENSIONS

- ▶ Housing dimensions (LxWxD): 105 x 62 x 75 mm

TECHNICAL DRAWING

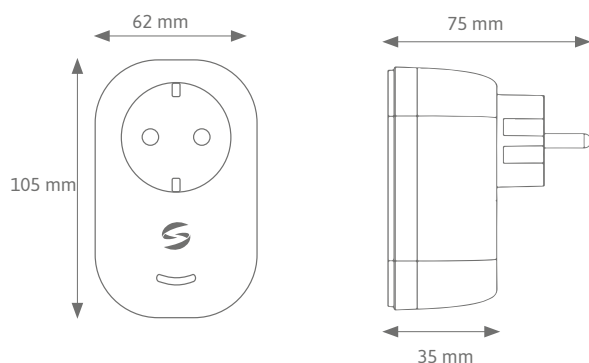

TECHNICAL FEATURES

- ▶ Transmission protocol: RF 433 mhz
- ▶ Range (without mesh): 30 meters (in buildings)
- ▶ IP Rating: IP20
- ▶ Input voltage: 220 - 240 AC 50/60Hz
- ▶ Output power: 1 channel / 16 A
3680 watts (~ 220V AC)
1500 watts (~ 220V AC LED)
- ▶ Standby Power: <0.3 watts
- ▶ Receiver Sensitivity: -110dBm
- ▶ Operating temperature: 0°C to +55°C

MOUNTING PROFILE

ONE4ALL FOR 8MM

ONE4ALL - Aluminium Profile

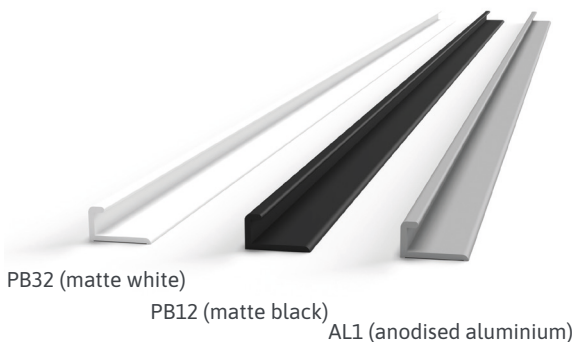

Areas of Application:

- ▶ Kitchen countertop lighting
- ▶ Plinth/base lighting
- ▶ Indirect ambient lighting
- ▶ Task lighting for work surfaces
- ▶ Lighting solutions for shelves, cabinets and display cases

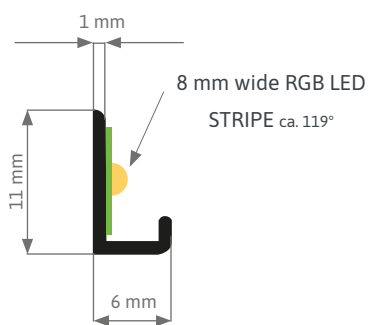

- ▶ Elegant and Versatile
- ▶ Quick installation thanks to simple adhesive mounting – strong adhesion guaranteed!
- ▶ Just apply the LED strip, remove the adhesive backing, and press the profile into place.
- ▶ Slim design – blends perfectly into any interior and is ideal for shelves, cabinets, or display cases.
- ▶ Can be mounted horizontally or vertically.
- ▶ Suitable for 8 mm wide RGB LED strips.
- ▶ Available in matte black (PB12), matte white (PB32) or anodised aluminium (AL1).
- ▶ Optimised for LED Lighting – No Cover Needed
- ▶ Our aluminium LED profile is specially designed for furniture lighting and offers a beam angle tailored for this purpose. Without a diffuser cover, no light is lost, making the illumination particularly effective and energy-efficient.
- ▶ Also functions as a heat sink for LED strips.
- ▶ Available in 2000 mm and 2950 mm lengths.



Article No.	Length	Product Dimensions (LxWxH)	Colour	Packaging Unit
SL-PR148AL1-2M-V10	2000 mm	2000 x 11 x 6 mm	Anodised aluminium	10
SL-PR148AL1-3M-V10	2950 mm	2950 x 11 x 6 mm	Anodised aluminium	10
SL-PR148PB12-2M-V10	2000 mm	2000 x 11 x 6 mm	matte black	10
SL-PR148PB12-3M-V10	2950 mm	2950 x 11 x 6 mm	matte black	10
SL-PR148PB32-2M-V10	2000 mm	2000 x 11 x 6 mm	matte white	10
SL-PR148PB32-3M-V10	2950 mm	2950 x 11 x 6 mm	white	10

FASHION FOR FURNITURE



Trade Partners



Lightsolutions



DIY & Retail



toolmaking



mobile living



industry



Innovative. Sustainable. Reliable.

At SIRO, we believe in the power of innovation and our responsibility to the environment and society. Certifications such as FSC and BSCI reflect our deep commitment to these values. We follow a comprehensive strategy to reduce our carbon footprint – from production to delivery.

As a third-generation Austrian family business, we have been setting standards in the DIY sector for over 75 years by developing forward-looking solutions and acting sustainably. Whether for the caravan sector with its specific requirements or the broader mobile living industry – as a manufacturer of decorative furniture fittings, we stand for the highest quality and reliability.

With a strong focus on quality, innovation, and social responsibility, we work together with our partners and customers to shape a liveable future.

At SIRO, sustainability is a lived value, embedded in every aspect of our business.

Toolmaking:

From the initial idea to mass production, we support you with state-of-the-art CAD technology and our in-house toolmaking expertise.

DIY und Baumärkte:

Our products are perfectly tailored to the needs of DIY enthusiasts and are available in numerous home improvement stores.

Specialist Trade:

With over 3,000 stocked items, we offer an impressive range of fittings readily available for specialist retailers.

Our close cooperation with renowned international designers ensures our products are always in step with the times – not merely following trends, but setting new standards. Thanks to our own production facilities for plastic injection moulding, zinc die casting, wood processing, and surface finishing, we maintain maximum quality and flexibility across all areas of manufacturing.



Join the SIRO community – get news, trends, and inspiration delivered to you.

SIRO Beschläge- und Metallwarenfabrik Ges.m.b.H. | Spielfeldstraße 12 | A-4452 Ternberg | Austria
Tel: +43.(0)7256.6020.0 | Fax: +43.(0)7256.8932 | E-Mail: office@siro.at | www.siro-led.at

