

SL-PPREC02TRIAC

230V AC TRIAC SWITCH

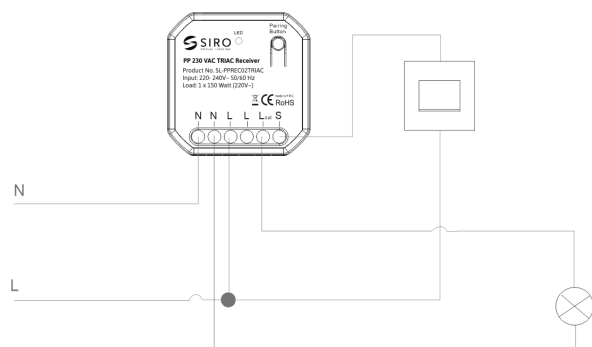

CONNECTION PLAN



N Neutral conductor
L Manager
S Terminal for wired push switch
Lout Ladder for LED light

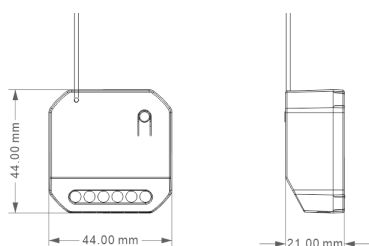

PRODUCT FEATURES

- ▶ 230V AC MONO TRIAC receiver as receiver for push power switch
- ▶ Connection of dimmable LED-capable luminaires on a 230V AC basis.
- ▶ Up to 10 switch buttons (2-way or 4-way switches) or switch components can be connected.
- ▶ Radio-based range up to 80 meters.
- ▶ Functions: ON - OFF - DIMMING
- ▶ Product has a memory function (last light setting)
- ▶ Repeater Mesh function to activate & deactivate

ASSEMBLY

- ▶ In appliance box to DIN 49073, in the light fitting (ceiling lights), individual positioning.
- ▶ Installation may only be carried out by qualified electricians.

DIMENSIONS

- ▶ Housing dimensions (LxDxH): 44 x 44 x 21 mm

TECHNICAL FEATURES

- ▶ Transfer protocol: RF 433 mhz
- ▶ Range (without mesh): 30 meters (indoors)
- ▶ IP Rating: IP20
- ▶ Input voltage: 220 - 240V AC 50/60Hz
- ▶ Output power: 1 channel / 1.5 A
150 Watt (~ 220V AC) - Led
- ▶ Standby Power: ≤ 1W
- ▶ Receiver Sensitivity: -110dBm
- ▶ Operating temperature: 0°C to 40°C
- ▶ Connecting socket: 2,6 x 2 mm
- ▶ Cable cross-section: 2.5 mm² Rigid cable/solid conductor
1.5 mm² Stranded cable

SAFETY AND INSTALLATION INSTRUCTIONS

- ▶ **Attention, this product is operated with 230V AC voltage!**
- ▶ Installation may only be carried out by qualified electricians.
- ▶ This product is not a toy and is not suitable for children!
- ▶ The SIRO LED system is only suitable for indoor use. Unprotected outdoor use is not permitted. Contact with moisture must be avoided at all costs!

RoHS

Must not be disposed of with household waste.
Must not be disposed of in household waste.

SIRO fittings and metal goods factory
Spiefeldstrasse 12
4452 Ternberg, Austria

Tel . +43 (0)7256.6020.0
Fax . +43 (0)7256.8932
E-mail office@siro.at
Web . www.siro.at

© 2023 All rights reserved. All rights reserved

GENERAL FUNCTIONS

1, 2, 3, 4

Single click:

Click and hold:

Click and hold when switched off:

Single click with door sensor

2 or 4-way buttons

Switching on or off

Dimming 0 - 100%

Night mode (5% brightness)

Switching on or off

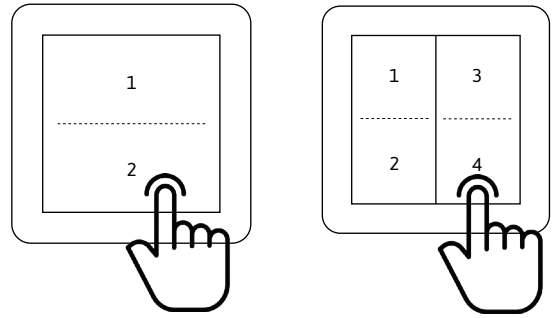

POSSIBLE COMBINATIONS

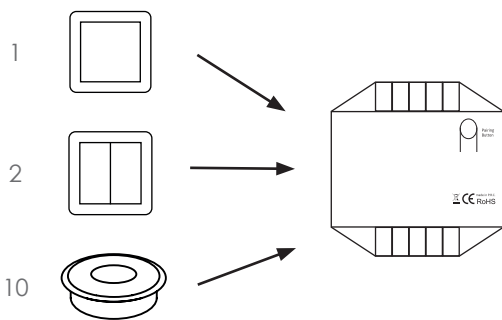

More controls on one receiver

a maximum of 10 PushPower control units (sensors, push buttons, etc.) can be connected to one receiver.

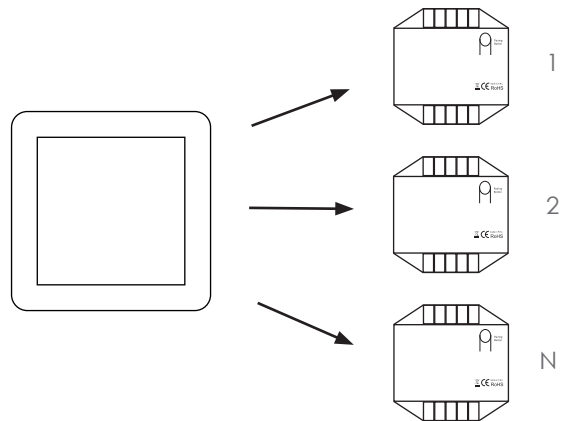

One control on several receivers

1 PushPower control unit can control any number of receivers to control.

CONNECTING THE CONTROL UNIT & RECEIVER

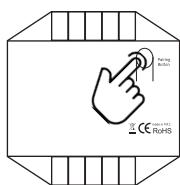

press and hold for 3 seconds

Indicator light on the receiver flashes

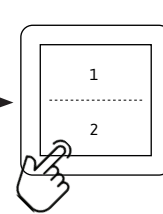

or

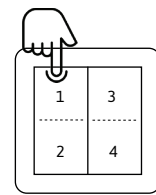

or

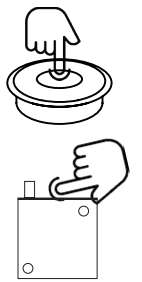

Press any button on a PushPower control unit.

2-way switch (2 options) or 4-way switch (4 options) or press the contact point for sensors

RESET RECEIVER

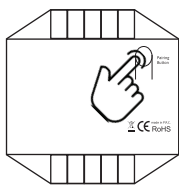

press and hold for 7 seconds

Indicator light on the receiver flashes



Indicator light on the receiver lights up continuously and then switches off

RoHS 

Must not be disposed of with household waste.
Must not be disposed of in household waste.

SIRO fittings and metal goods factory
Spielfeldstrasse 12
4452 Ternberg, Austria

Tel . +43 (0)7256.6020.0
Fax . +43 (0)7256.8932
E-mail office@siro.at
Web . www.siro.at

© 2023 All rights reserved. All rights reserved