

SL-CAB2-SS
connection plug



PRODUCT PROPERTIES

- » MONO LED connection plug
- » 2 pole plug connector
- » solder-less connection
- » **suitable for 8 mm wide MONO LED stripes**
- » connection to LED stripes through simple clasp system
- » packaging unit: 1 pcs

DIMENSIONS

- » length: 20,6 mm
- » width: 11,0 mm
- » height: 4,5 mm
- » pin distance: 3,6 mm
- » LED stripe width: 8 mm
- » LED stripe thickness: 0.2-0.4 mm

TECNICAL SPECIFICATIONS

- » nominal current: 6 A
- » IP 20
- » operating temperature: -35° - +60° C
- » storage temperature: -35° - +80° C

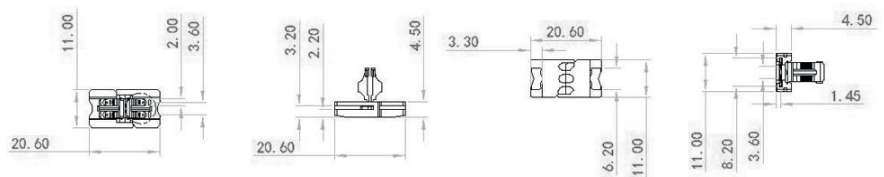
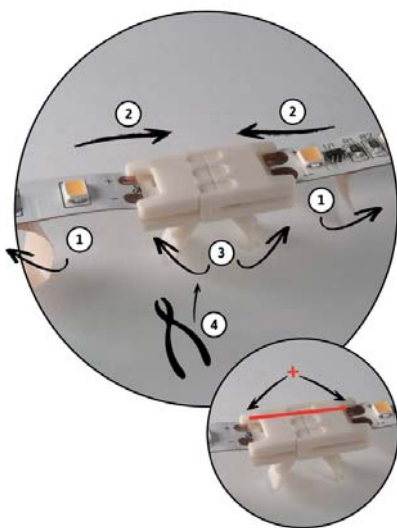

SAFETY- AND ASSEMBLYHINTS

- » this product is not a toy and not suitable for children!
- » the assembly has to be done without an electric current!
- » the LED products have quite fragile, electric components which shouldn't be put under mechanical stress.
- » mount the LED stripes onto immovable components, which are free from tensions.
- » the SIRO LED system has to be used indoors. Unprotected use outdoors is not permitted. The contact with moisture/fluids has to be avoided at all costs!



Can **not** be disposed into domestic waste.

SIRO Beschläge- und
Metallwarenfabrik
Spielfeldstraße 12
4452 Ternberg, Austria

Tel . +43 (0)7256.6020.0
Fax . +43 (0)7256.8932
E-Mail office@siro.at
Web . www.siro-light.at

© 2015 Alle Rechte
vorbehalten.